

FAIRWAY

ARCHITECTURAL RAILING SOLUTIONS



A210 Aluminum Railing Installation Guide



NOTE: Gap between deck and bottom rail should not exceed 4" (residential), 2" (commercial). It is the responsibility of the installer to meet or exceed all code and safety requirements, and to obtain all required building permits. These instructions are only a guide and may not address every circumstance. The deck and railing installer should determine and implement appropriate installation techniques for each situation. Fairway Building Products shall not be held liable for improper or unsafe installations.



Fairway Architectural Railing Solutions will not be held liable for incorrect or unsafe installations by the installer. It is the installer's responsibility to secure proper building permits, review local codes and safety needs and meet or exceed them. The instructions provided by Fairway are a guide and may not account for every special circumstance. The installer must identify and execute the installation approach that is appropriate for every application.

LEVEL INSTALLATION

LEVEL KIT INCLUDES:

1 - Top Cap Rail

2 - Pre-Machined Rails

Balusters - 6' kit - 16, 8' kit - 22

4 - Mounting Brackets & Hardware Covers

1 - Foot Block

8 - #8 x 1-1/2" Stainless Steel Screws

8 - #8 x 3/4" Stainless Steel Screws

DECK INSTALLATION

(Hardware not included)

Step 1

Determine post mount location. Screw two (2) 2" x 12" blocks together and install them between joists in deck framing. 2" x 6" wood block wood grain should run perpendicular to joists in deck framing. Insert (4) #10 x 3" exterior grade screws evenly spaced in 4 sides of 2" x 6" blocking.

Step 2

Install deck covering.

Step 3

Lay out where post will be mounted. Mark holes at 4 corners of post flange on deck surface. Drill (4) 7/16" holes through deck surface and 2" x 6" blocking.

Step 4

Insert four (4) 3/8" x 6" bolts into the pre-drilled 7/16" holes. Install washers and 3/8" nuts. Insert shims under post base around mounting bolts for leveling. Trim shims flush with post base. Securely tighten all four bolts.

SUGGESTED BLOCKING

for installing flanged post on wooden structure

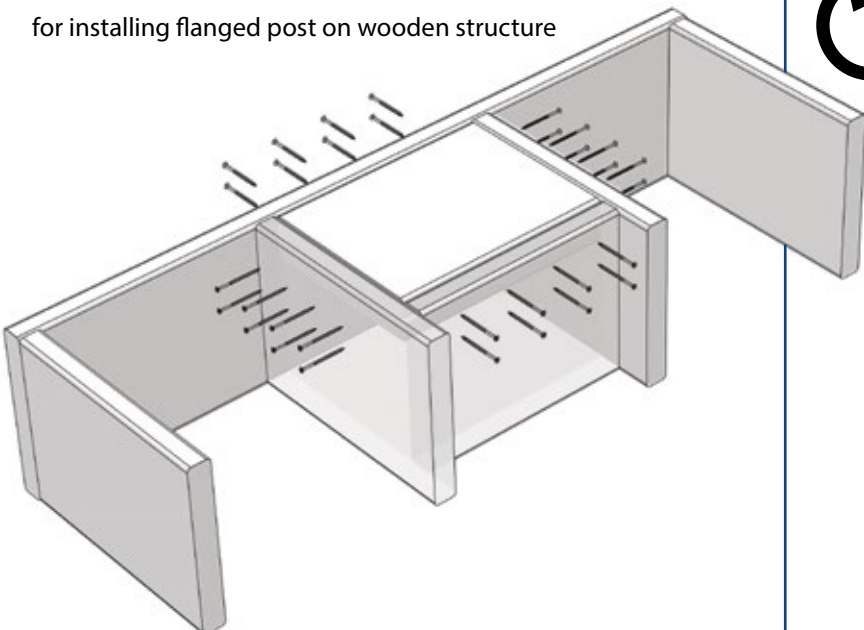

CONCRETE INSTALLATION

(Hardware not included)

Step 1

Lay out where post will be mounted and mark holes at (4) corners of base plate. Drill (4) holes per concrete wedge anchor manufacturer's suggested pre-drill size.

Step 2

Insert 3/8" concrete wedge anchors into (4) pre-drilled holes. Install post.

Step 3

Install and tighten concrete wedge anchor hardware washers and bolts following concrete wedge anchor manufacturer's recommended installation. Insert shims under post base around mounting bolts for leveling. Trim shims flush with post base. Securely tighten all four bolts.

1

SECURE POST

Plumb all posts or mounting surfaces.

Do not install post trim at this time. Post trim should be installed at completion of railing installation.

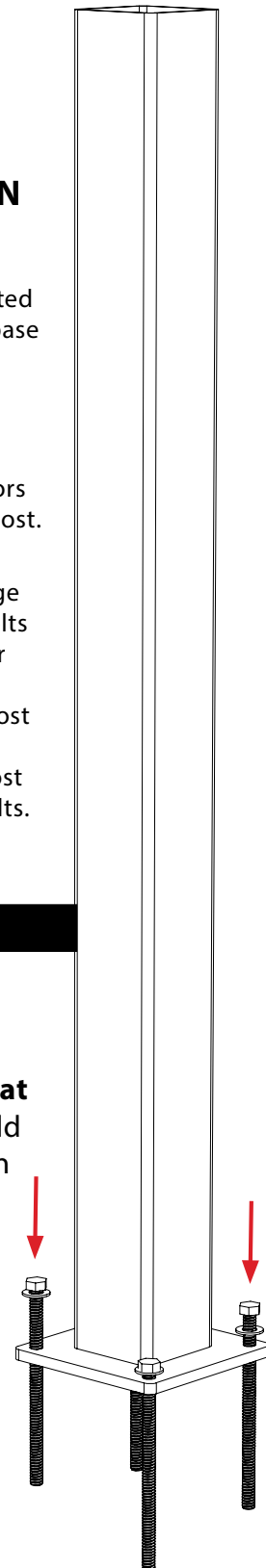

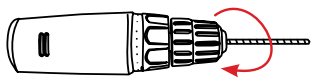

TIP: Lower drill/driver torque settings.
Full torque settings may snap stainless steel screws.

2 SECURE TOP BRACKETS

Insert brackets into template provided in kit per the desired rail height.

Middle bracket location is for 36" high, top bracket location is for 42" high.

Use a rubber band or hand clamp to hold installation template tight to post.

Top Bracket

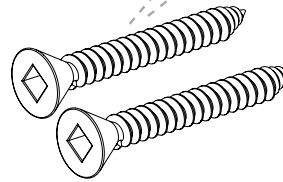
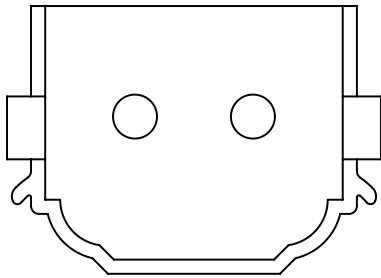

#8 x 1-1/2" Screws

3 SECURE BOTTOM BRACKETS

Install two (2) #8 x 1-1/2" flat head self-tapping screws per bracket in to post bracket holes.

Remove installation template and repeat on the opposite post.

Bottom Bracket

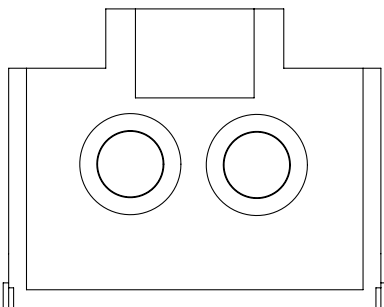

#8 x 1-1/2" Screws

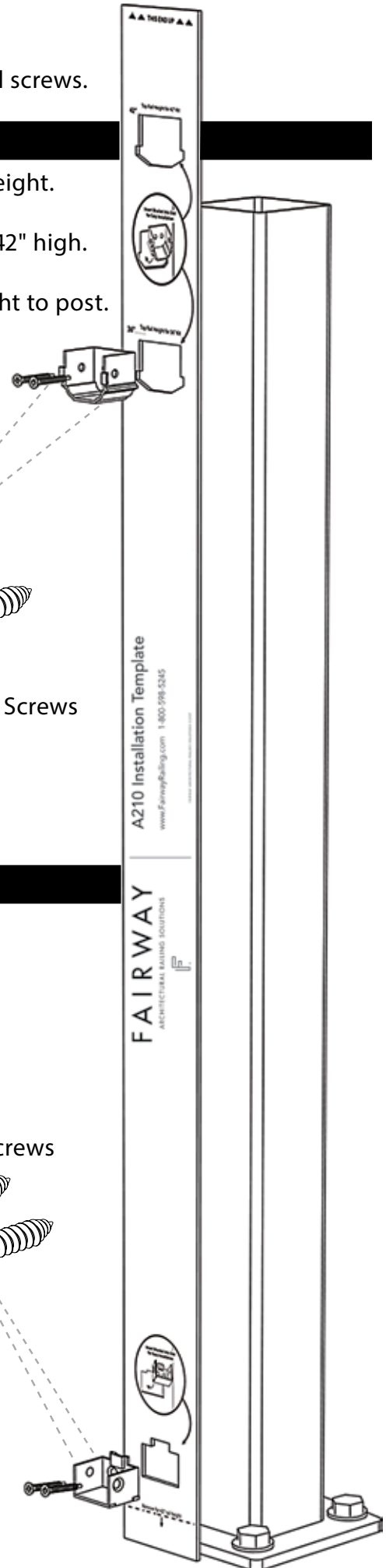
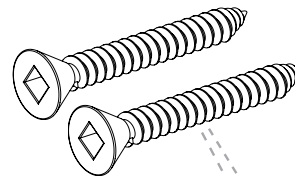

4

Measure distance between finished posts or mounting surfaces.

Deduct 3/16" from total length to allow for mounting brackets.

Mark bottom rail to correct length. Ensure there is equal & maximum distance from baluster holes on both ends.

Cut bottom rail (A), top sub rail (A), and top cap rail (B) the same length. BE SURE BALUSTER HOLES LINE UP.

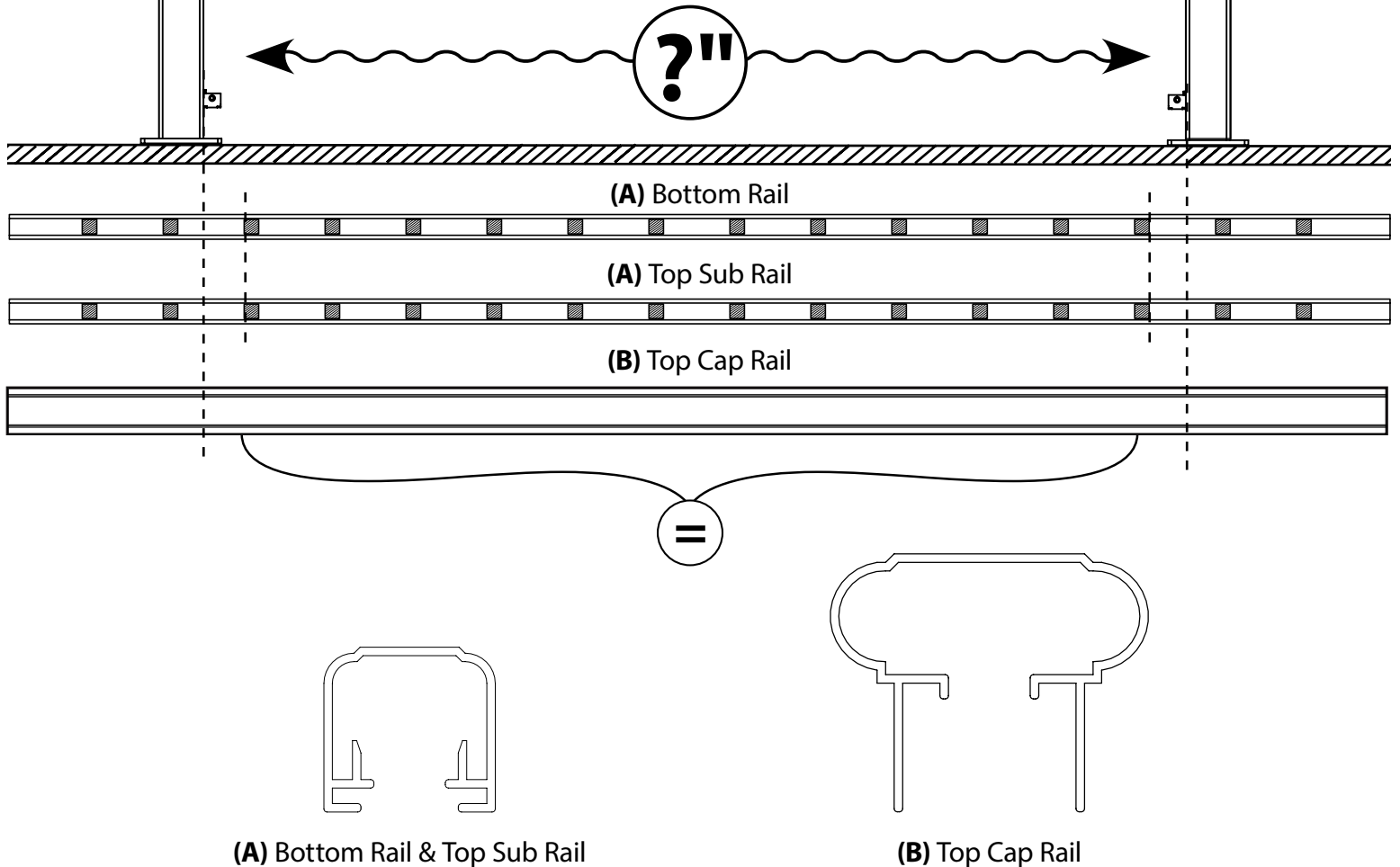

5

INSTALL BALUSTERS

Place bottom rail on cardboard from rail packaging. Using a rubber mallet, tap balusters into routed holes making sure balusters are fully seated into the rail.

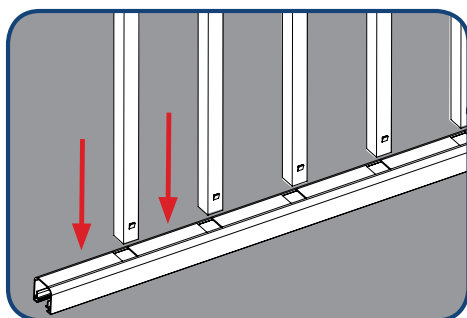

3/4" Baluster

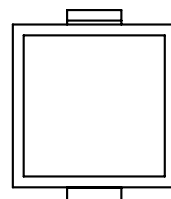

32" Baluster = 36" Rail Height

38" Baluster = 42" Rail Height

6

SECURE CAP RAIL

Holding the sub rail at an angle above the balusters, start at one end to insert first baluster and tap lightly.

Insert remaining seated balusters into rail.

Make sure all balusters are seated completely in both bottom and sub rails.

Slide top cap rail over sub rail.

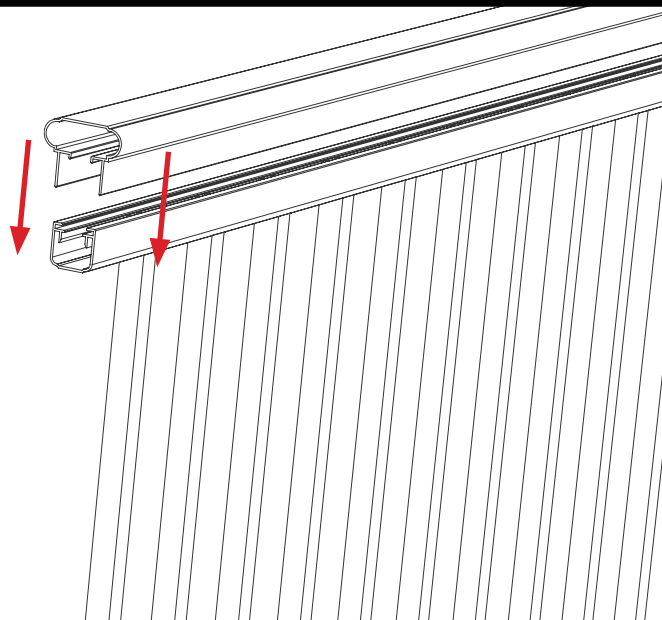

7

ASSEMBLE

(A) Slide top rail bracket covers onto assembled top rail on both sides.

(B) Carefully set assembled rail panel into brackets.

(A)

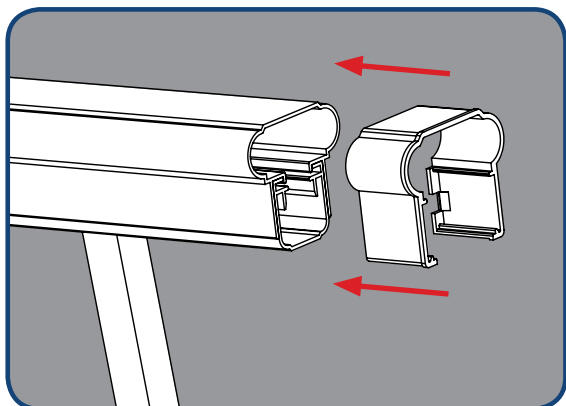

(B)

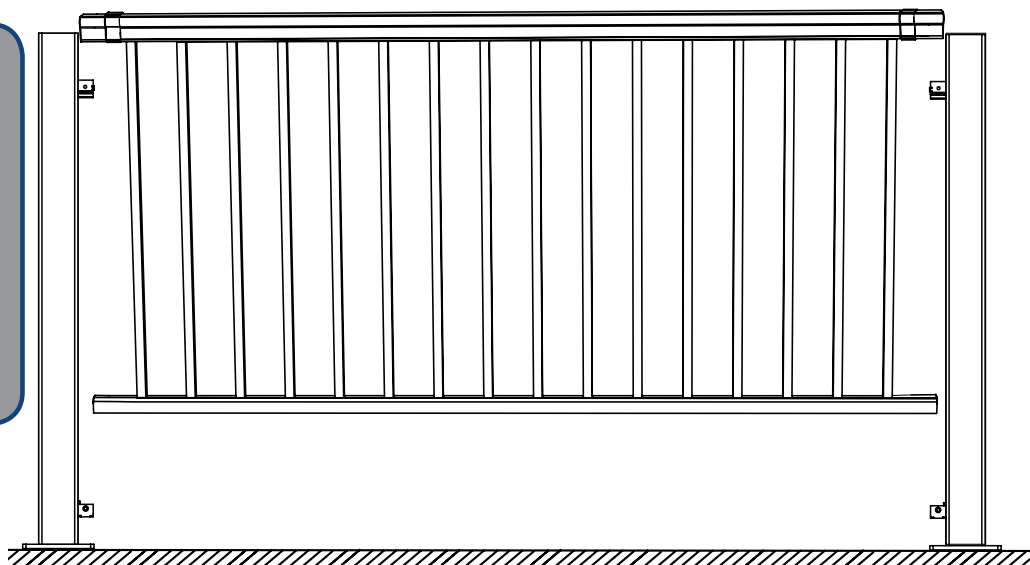

8

SECURE BRACKETS

Secure rails by installing two (2) #8 x 3/4" Pan Head self-tapping screws through holes in both sides of each bracket. Snap Covers on all brackets.

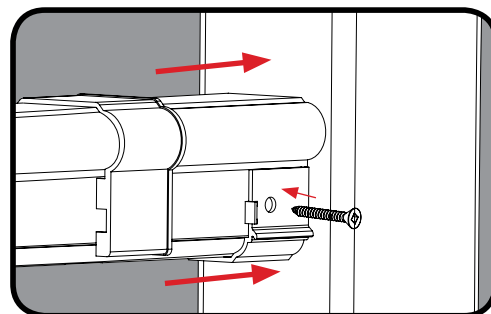
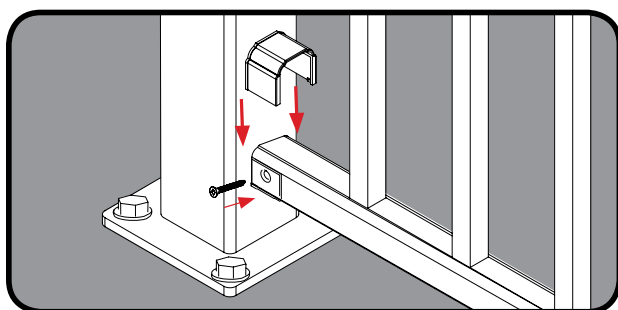

9

INSTALL FOOT BLOCK

Measure from the deck surface to the underside of the bottom rail.

Cut foot block to the measured length.

(A) Cutting Foot Block

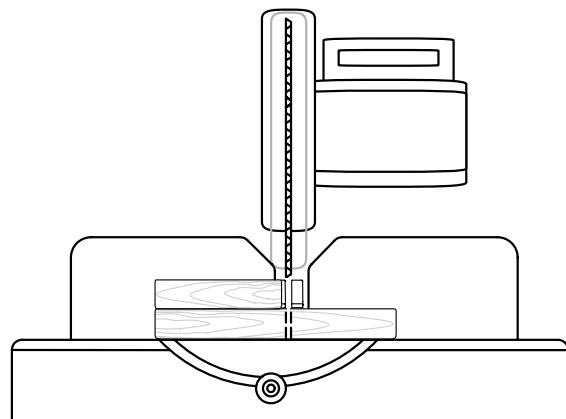
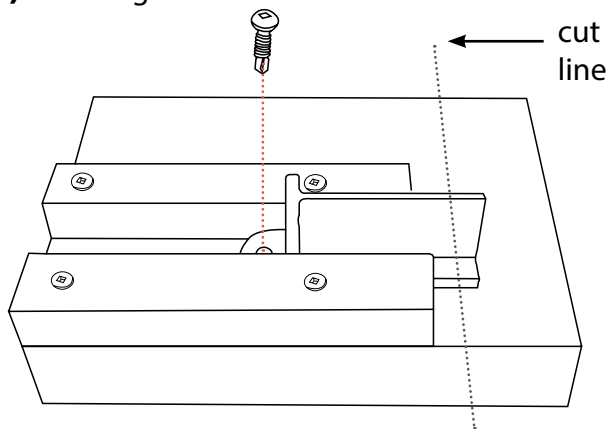

NOTE: When cutting the foot block secure two spare wood blocks with screws on each side to hold foot block in place while being cut down to proper size.

(B) Secure Foot Block

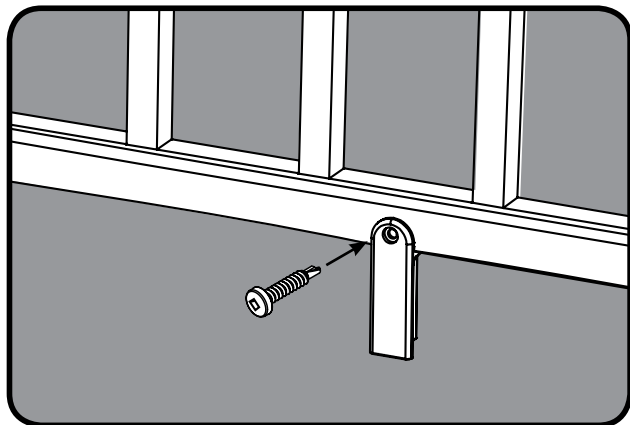

Measure to the center of the bottom rail.

Slide the cut foot block under the bottom rail and attach with included screw.

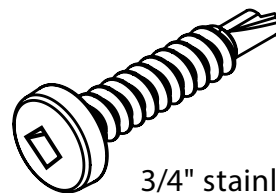

3/4" stainless steel screw

10

INSTALL POST CAP & TRIM

(A) Install two-piece, snap-together trim to cover post flange.

NOTE: Post trim is secure when locked. Put together when job is complete so no adjusting is needed.

(B) Tap post cap in place with rubber mallet.

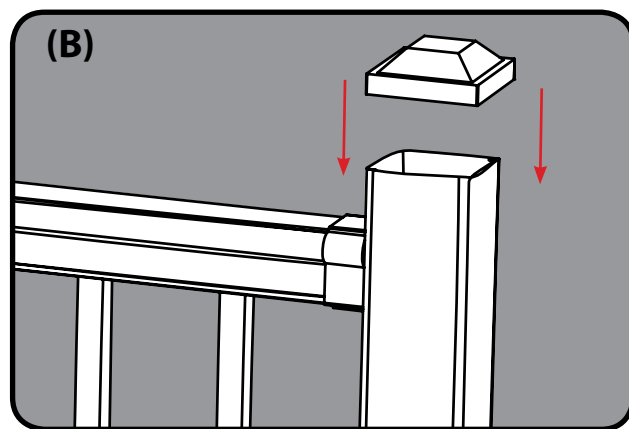
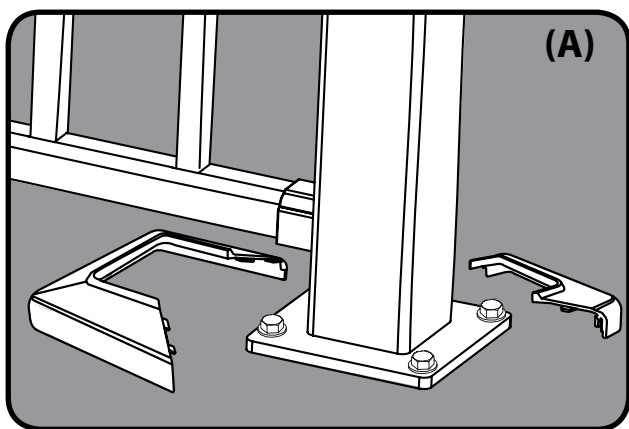

STAIR INSTALLATION

STAIR KIT INCLUDES:

1 - Top Cap Rail

2 - Pre-Machined Rails

Balusters - 8' kit - 21

4 - Mounting Brackets for Stairs (Top & Bottom)

8 - #8 x 1-1/2" Stainless Steel Screws

2 - #8 x 3/4" Stainless Steel Screws

1 ASSEMBLE RAIL SECTION

Lay rail section next to posts on stair run.

Clamp rail section to posts.

Balance out baluster spacing at the top & bottom of stairs.

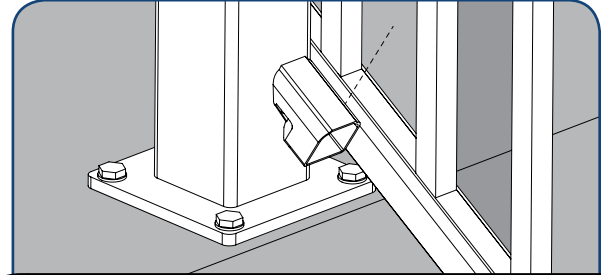
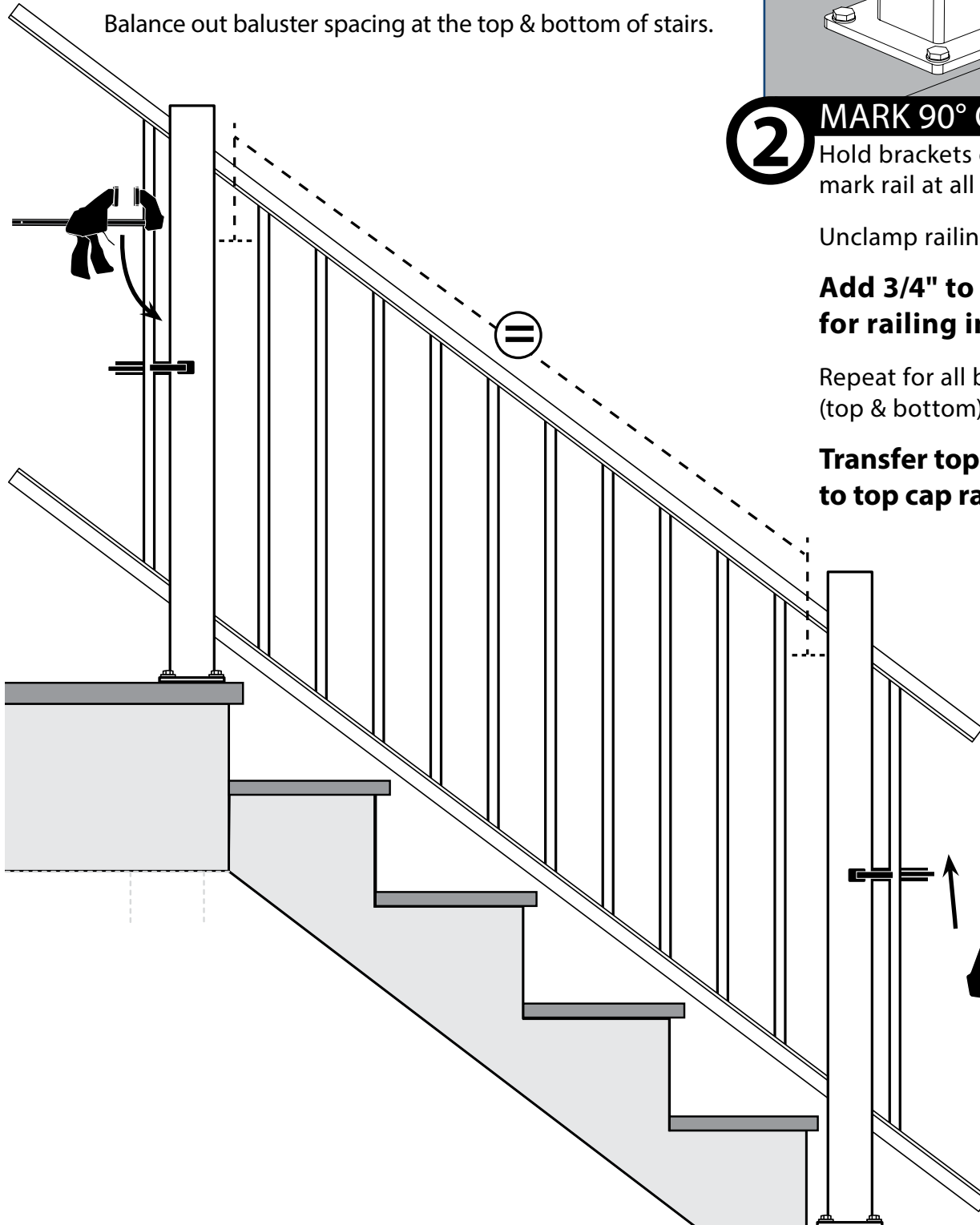

2 MARK 90° CUT LOCATIONS

Hold brackets on post next to rail & mark rail at all bracket locations.

Unclamp railing section from post.

Add 3/4" to bracket mark for railing into the bracket.

Repeat for all bracket marks (top & bottom).

Transfer top rail measurement to top cap rail.

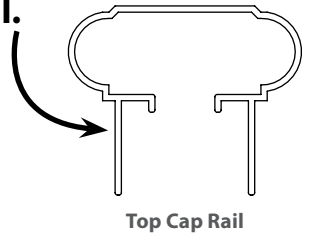

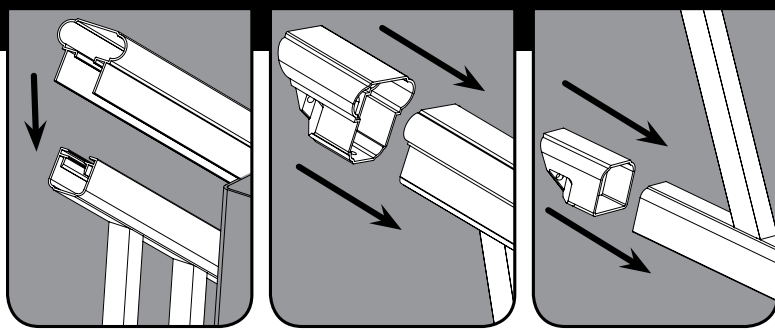

3

CUT RAIL SECTION TO LENGTH

Slide top cap rail onto top sub rail.

Cut rail assembly at all 3/4" marks at a 90° angle.

Slide brackets on rail (top & bottom).

4

INSTALL STAIR RAIL SECTION, SECURE BRACKETS TO POST

Place rail section between posts.

Pre-drill bottom bracket holes using a 1/8" drill bit.

Install provided 1-1/2" stainless steel screws.

Repeat for opposite bottom rail bracket.

Repeat for both top rail brackets.

**STAIR - TOP
& BOTTOM
BRACKET**
(insert screw
in both sides
of brackets)

x2

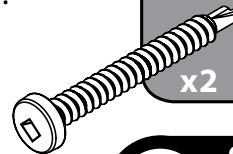

5

SECURE BRACKETS TO RAIL

Pre-drill using a 1/8" drill bit.

Install provided 3/4" stainless steel screw into top brackets.

**STAIR -
TOP RAIL BRACKETS**

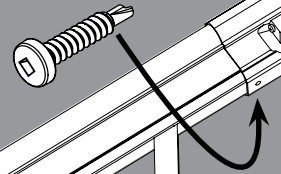

6

INSTALL CAP & TRIM

Tap post cap in place.

Install two-piece, snap-together trim.

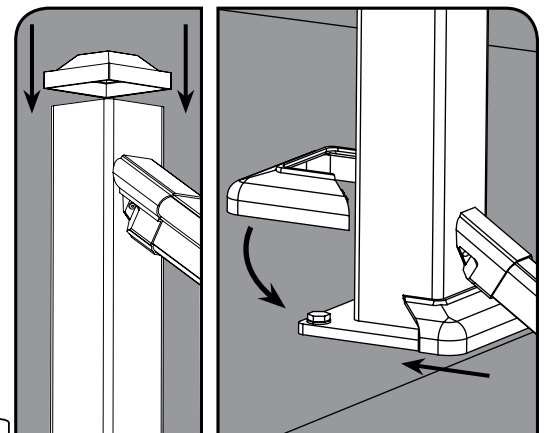

ANGLE RAILING INSTALLATION GUIDE

1

INSTALL BOTTOM BRACKET BASE

Measure to bottom of bottom rail bracket on a straight rail section.

Deduct 3/8". Mark post on center.

Install bottom rail bracket base using (2) #8 x 1-1/2" stainless steel hardware.

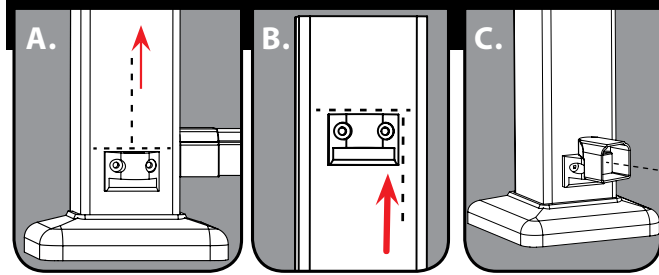
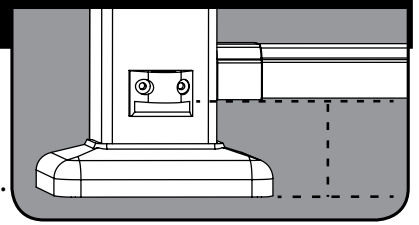

2

INSTALL BRACKET BASES, MEASURE RAIL SECTION

A. Measure up (32-1/4" for 36" rail height, 38-1/4" for 42" rail height) from top of bottom bracket. **B.** Mark post. Install top rail bracket base using (2) #8 x 1-1/2" stainless steel hardware.

C. Install bottom rail bracket cups. Measure between inside of bottom rail bracket cups.

3

CUT RAIL SECTION TO LENGTH, INSTALL BRACKETS

See level installation guide for rail section assembly.

Cut rail section assembly to length based upon previous measurement. Slide brackets on rail (top & bottom).

Install set screw and (1) #8 x 3/4" stainless steel screw into top rail bracket. Install post cap and trim.

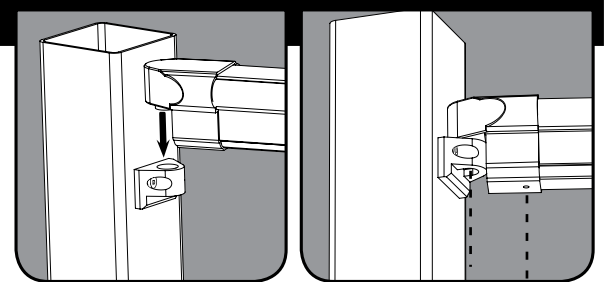

TECHNICAL SPECS

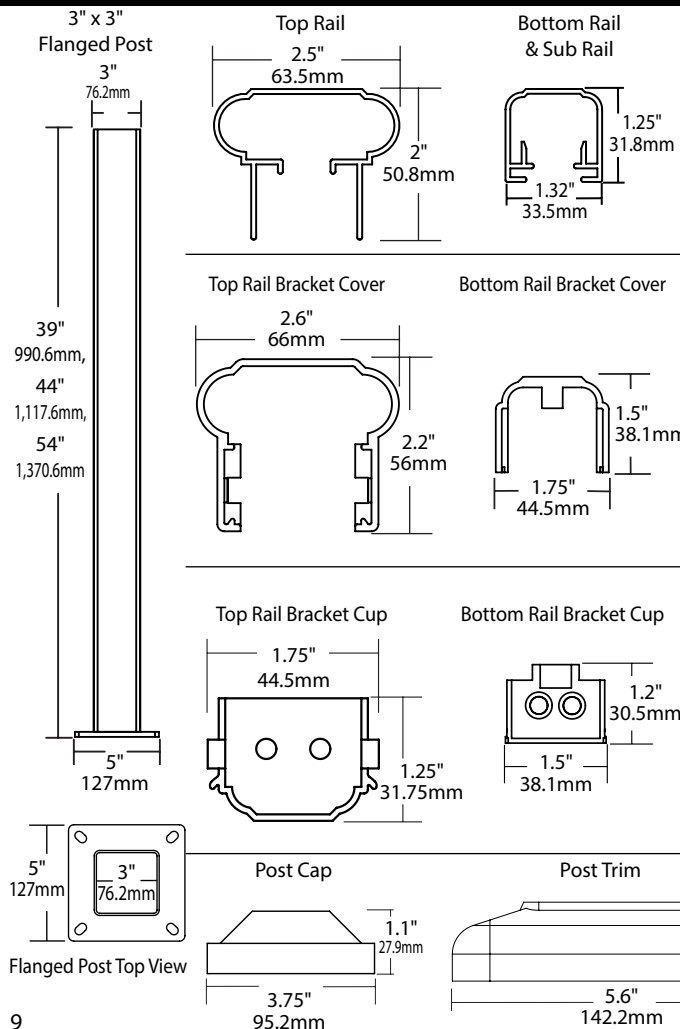

		Level & Stair Rail Kit	
		RAIL HEIGHT	
		36"	42"
	A	36"	42"
	B	32"	38"
	C	3.5"	3.5"
72" Level - 16 balusters		96" Level - 22 balusters	
		96" Stair - 21 balusters	

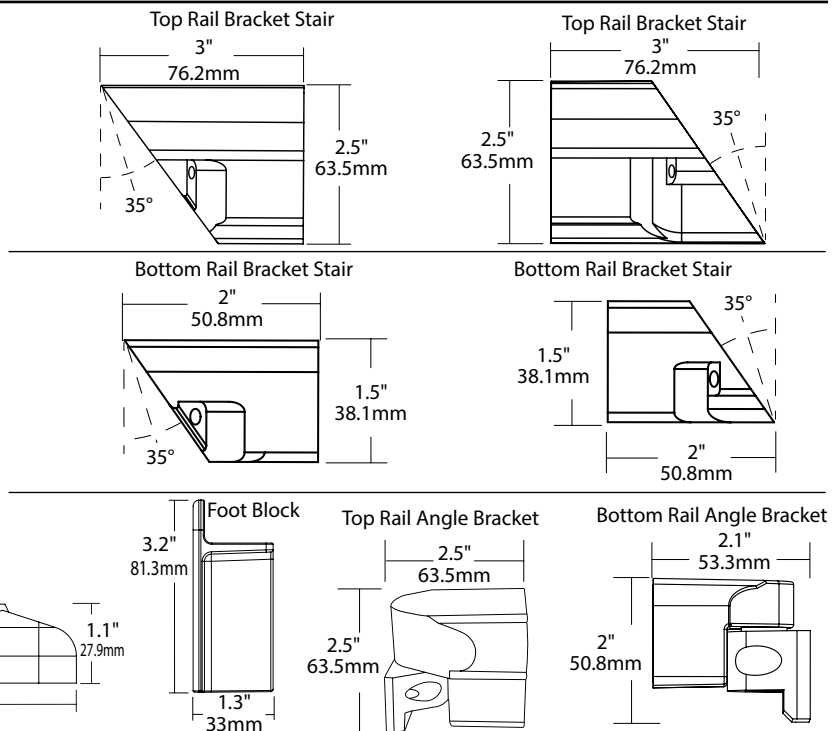

CLEANING AND MAINTENANCE TIPS FOR YOUR RAILING

It's easy to maintain the great look of your Fairway Aluminum System. Like anything exposed to the elements, your railing or fence will get dirty, but in most cases you can simply spray the dirt off with your garden hose. For more stubborn dirt or stain removal, follow these simple instructions:

NOTE: BE SURE TO PROTECT SHRUBBERY FROM DIRECT CONTACT WITH CLEANING AGENTS.

Stubborn Dirt

1. Use a slightly moist Mr. Clean Magic Eraser Cleaning Pad® to scrub your railing or fence. This should remove most stains.
2. Use an ordinary soft bristle wash brush and scrub your railing or fence just like you would wash your car.
3. If the dirt is difficult to remove, such as soot found in industrial areas, wash the railing or fence with a solution made up of the following:
1/3 cup powder detergent (e.g. Tide, Fab, or equivalent powder detergent)
2/3 cup household cleaner (e.g. Soilax, Spic & Span or equivalent)
1 gallon of water
4. If mildew is a problem in your area add 8 fluid ounces of liquid laundry bleach to above solution.
5. When washing your railing or fence, prevent streaking by starting at the bottom and working up to the top.
6. If stubborn stains exist, follow the precautionary labeling instructions on the cleaning agent container.

Stain Removal

1. Light oils and greases, heavy grease, caulking compounds, wax, crayon, asphalt, tars, etc.:
 - a. Use a slightly moist Mr. Clean Magic Eraser Cleaning Pad® scrub your railing or fence.
 - b. Cleaning Agents: Mineral spirits, VMP naphtha, auto tar remover.
 - c. Preparation: Remove excess with plastic or wood scraper.
 - d. Special cleaning procedures: Use soft cloth to apply mineral spirits.** Maintain light pressure to avoid polishing stained area. After removing stain, rinse area thoroughly with clean water.
2. Inks (marking), nail polish, paint, lipstick, gum:
 - a. Cleaning agents: Cleaning fluid (Trichloroethylene)
 - b. Preparation: Remove excess with plastic or wood scraper. Chill gum to remove excess.
 - c. Special cleaning procedures: Use soft cloth to apply cleaning fluid*.* Maintain light pressure to avoid polishing stained area. After removing stain, rinse area thoroughly with clean water.
3. Rust stains:
 - a. Cleaning agents: Oxalic acid, auto radiator cleaner, Bright bowl®, Ridco-Rust
 - b. Preparation: Make solution of 1 tablespoon of oxalic acid crystals to 1 cup warm water.
 - c. Special cleaning procedures: Apply oxalic acid solution with soft bristle brush. Wipe with damp cloth and then flush with rust free water (use rubber gloves and eye protection).
4. Stubborn Stains:
 - a. Use a slightly moist Mr. Clean Magic Eraser Cleaning Pad® scrub your railing or fence.
 - b. Cleaning agents: Xylene, Lacquer Thinner procedure.
 - c. Preparation: Try procedures 1, 2, or 3. If they don't remove the stains, then use this procedure.
 - d. Dampen small section of cloth with xylene. Rub vigorously on the affected area.** Maintain light pressure to avoid polishing stained area. After removing stain, rinse area thoroughly with clean water.

INSTALLER

Leave this page with property owner or manager.

PROPERTY OWNER/MANAGER

Register warranty at FairwayRailing.com/warranty-registration.

15 YEAR LIMITED WARRANTY TERMS, CONDITIONS AND LIMITATIONS

1. The manufacturer's (FAIRWAY Architectural Railing Solutions (FAIRWAY®) sole liability and the owner's only remedy shall be as follows:
 - a. If a problem occurs, FAIRWAY, at its sole discretion, may elect either to repair or replace the defective part(s) of the railing or provide reimbursement limited to cost of materials at time of purchase. Due to normal aging and weathering of material, it may not be possible to perfectly match the colors of the old and new materials and therefore FAIRWAY is not responsible for any color differences that may occur. FAIRWAY is not responsible for discontinuance of a color.
2. FAIRWAY warrants only those products manufactured and sold under the A210 (Slimline) and A310 (Solutions) name. This Limited Warranty extends only to the original purchaser according to terms specified herein. FAIRWAY shall not be liable for and this warranty does not apply to any terms, failure, defect or damage resulting from or connected with the following:
 - a. Defects not caused by FAIRWAY (for example, but not limited to: accidents, misuse, improper applications or installations contrary to industry or A210 (Slimline) and A310 (Solutions) standards).
 - b. Product that has been painted or had its surface treated or cleaned with an abrasive chemical or material.
 - c. Product subject to impact of foreign objects, tornado, hurricane, other violent storms, fire, air pollutants, normal weathering of surfaces, abnormal discoloration due to improper maintenance, or any other acts of God.
 - d. Improper installation of A210 (Slimline) and A310 (Solutions) or defects caused by their installation.
 - e. A210 (Slimline) and A310 (Solutions) Limited Warranty will not be applicable for products that are covered by a specific and separate warranty or duration.
 - f. Products sold, shipped or installed outside of the Continental United States shall have a limited duration of this coverage to 10 years from date of purchase.

For complete warranty please go to our website.

WARNING: Fairway Architectural Railing Solutions and its employees are not qualified to approve, recommend or advise as the suitability of this product for all possible local code requirements and end use applications. Your local code authority or fire marshal's office should be consulted as to its safety for its intended uses. Like other building materials, Fairway Architectural Railing Solutions cannot be expected to contain spirited large stock animals, and therefore suggest additional measures using hot or tape wire as a deterrent and further makes no representation about and does not warrant against such an occurrence.

FAIRWAY® 15 YEAR LIMITED WARRANTY REGISTRATION PROCESS: Warranty registration can be accomplished electronically by visiting www.fairwayrailing.com/warranty-registration/ and registering within thirty (30) days after completion of installation of products in order for purchaser to be eligible for coverage under warranty terms. **NOTE: PROOF OF PURCHASE IS NECESSARY TO EXERCISE CLAIMS AND REMEDIES FOR ANY OCCASION. PLEASE SAFEGUARD ACCORDINGLY.** Upon receipt of all necessary information we will process and return a digital copy within thirty (30) days. The warranty will be certified and issued in PDF format to the email address supplied at the time of registration. If email is not available a hard copy will be mailed to the supplied address in lieu of the digital document. **CLAIMS AND REMEDIES:** A claim under this warranty must be reported in writing with proof of purchase to: Fairway Architectural Railing Solutions, P.O. Box 37, Mount Joy, PA 17552, within thirty (30) days of the date that the defect is first discovered or reasonably could be discovered. A reasonable time should be allowed for inspection purposes, or at FAIRWAY's option, shipment of a sample to the above address for examination of the alleged defective product. FAIRWAY shall be the sole judge of whether or not the material is defective and whether the defect is due to manufacturing defects. If, after its inspection, FAIRWAY determines the claim is in accordance with the terms of this Limited Warranty, FAIRWAY agrees at its option to replace the section or part of the product, or refund the prevailing cost of the product in your geographical area at the time of replacement or the original purchase price, whichever shall be less. This warranty does not cover the cost of removal of any defective products or the cost of installation of any replacement product furnished under the terms of the warranty. Incidental or consequential damages and resulting cost incurred as a result of a coverage claim are excluded and will not be paid. Statements, remarks, agreements, representations, promises or understandings, oral or written, contrary to the terms contained herein, even those made by an agent of FAIRWAY, will be recognized as neither implied warranties nor those of merchantability or fitness for use of specific applications. Some states may not allow the limitation of incidental or consequential damages or limitations on how long an implied warranty lasts, so many of the limitations may not apply to you. This warranty gives specific rights and there may also be other legal rights which vary from state to state. By acceptance and use of this product, purchaser agrees, that FAIRWAY liability and the purchaser's exclusive remedy for breach of any warranty shall be limited in all events to replacement of any section or part of this product which is found to be defective and shall be returned to FAIRWAY.