



TURNCRAFT

**COL** *Colonial Column*

- READY TO INSTALL
- WATER-REPELLENT TREATMENT
- AVAILABLE IN 6", 8", 10", AND 12"
- IN STOCK FOR IMMEDIATE SHIPMENT
- READY TO PRIME AND PAINT
- WOOD CAPS AND BASES AVAILABLE FOR INTERIOR USE
- POLYURETHANE CAPS AND BASES AVAILABLE FOR EXTERIOR USE
- TREATED WITH WOODLIFE® 111

## PRECISION CRAFTSMANSHIP

Turncraft Wood Colonial columns begin with the milling of finger-jointed or solid staves to exacting dimension. The staves are then assembled into a raw shaft using the strongest Type-I waterproof glue. Torque bands are wrapped around the shaft applying 90 to 100 pounds of pressure per square inch, transforming the individual staves into a single unit, ready for precision turning.

## TREATED AND PROTECTED WITH WOODLIFE® 111

Non-primed wood Colonial paint grade exterior shafts (except redwood or cedar) are fully immersed in Woodlife® 111 wood preservative. Woodlife® 111 is formulated to protect against staining and decaying fungi, to control shrinking, swelling, end checking, splitting, grain raising, and warping for maximum compatibility with paint, primers, and topcoats. Woodlife® 111 also conforms to Industrial Standard I.S. 4-00, is approved by the N.W.W.D.A., and meets all current and proposed government standards.

## UPON REQUEST:

Priming is applied in two coats, using a specially formulated primer developed exclusively for Turncraft. The column is sanded before each coat.

Asphalt coating of the shaft interior is applied to the bottom three feet of the shaft.

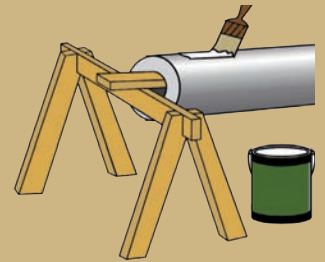

## PLAN TYPES

Colonial columns are available in the following plan types. Please specify when you order. Columns other than Plan Type A are not load bearing. Split or reassembled columns are not load bearing.



Colonial  
Tapered  
Round  
Smooth



Colonial  
Tapered  
Round  
Fluted



Colonial  
Non-Tapered  
Round  
Smooth



Colonial  
Non-Tapered  
Round  
Fluted

COLONIAL TAPERED COLUMN SPECIFICATIONS

Nominal shaft diameter *	Available heights	Shaft Dimensions				Fluting Dimensions			Maximum Load (pounds) Capacity
		Outside diameter		Inside diameter		Number of flutes	Flutes width	Flute length	
		Bottom	Top	Bottom	Top			(A)	
6"	6'	5 5⁄8"	4 1⁄4"	3"	1 3⁄4"	15	1⁄2"	4'-2"	2,095 lb.
	8'							6'-2"	
	10'							8'-2"	
	12'							10'-2"	
8"	6'	7 5⁄8"	6 1⁄4"	5"	3 1⁄2"	15	7⁄8"	4'-2"	3,258 lb.
	8'							6'-2"	
	10'							8'-2"	
	12'							10'-2"	
10"	6'	9 5⁄8"	8 1⁄4"	7 1⁄8"	5 1⁄2"	18	7⁄8"	4'-2"	4,268 lb.
	8'							6'-2"	
	10'							8'-2"	
	12'							10'-2"	
12"	6'	11 5⁄8"	10 1⁄4"	9"	7 1⁄2"	20	7⁄8"	4'-2"	5,173 lb.
	8'							6'-2"	
	10'							8'-2"	
	12'							10'-2"	

\* Shaft net diameters are 3/8" less than nominal.  
\*\* For wood columns, inside sizes are based on the inside diameter of the polyurethane cap. Other caps (wood and ornamental capitals) have different sizes and these numbers will not apply.

Column diameter	Tapered **	
	Inside round	Inside square
6"	1 1⁄2"	1 1⁄16"
8"	3"	2 1⁄4"
10"	5"	3 5⁄8"
12"	7"	5"

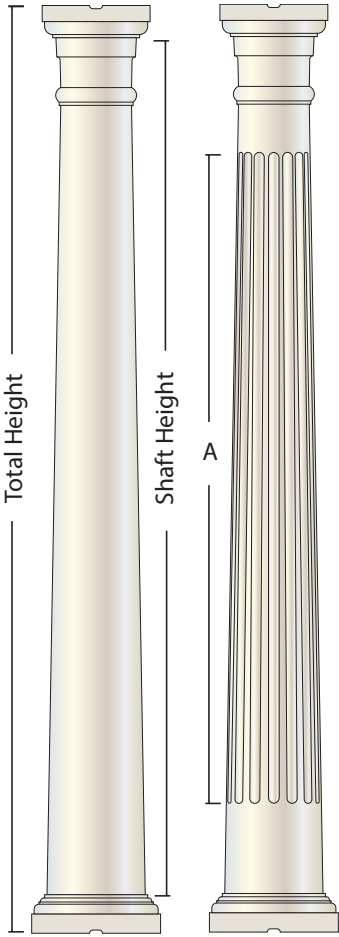
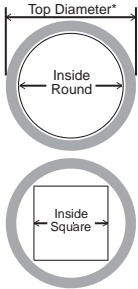

Turncraft manufactures a full selection of Colonial design columns in finger-joint western pine. Other species may be available upon request. Columns from 14" to 24" diameter are available. Call for more information.

COLONIAL NON-TAPERED COLUMN SPECIFICATIONS

Nominal shaft diameter *	Available heights	Shaft Dimensions		Fluting Dimensions			Maximum Load (pounds) Capacity
		Outside diameter	Inside diameter	Number of flutes	Flutes width	Flute length	
						(A)	
6"	6'	5 5⁄8"	3"	15	1⁄2"	4'-10"	2,095 lb.
	8'					6'-10"	
	10'					8'-10"	
8"	6'	7 5⁄8"	5"	15	7⁄8"	4'-10"	3,258 lb.
	8'					6'-10"	
	10'					8'-10"	
10"	6'	9 5⁄8"	7 1⁄8"	18	7⁄8"	4'-10"	4,268 lb.
	8'					6'-10"	
	10'					8'-10"	
	12'					10'-10"	
12"	6'	11 5⁄8"	9"	20	7⁄8"	4'-10"	5,173 lb.
	8'					6'-10"	
	10'					8'-10"	

\* Shaft net diameters are 3/8" less than nominal.  
\*\* For wood columns, inside sizes are based on the inside diameter of the polyurethane cap. Other caps (wood and ornamental capitals) have different sizes and these numbers will not apply.

Column diameter	Non-tapered **	
	Inside round	Inside square
6"	2 5⁄8"	1 7⁄8"
8"	4 5⁄8"	3 1⁄8"
10"	6 5⁄8"	4 3⁄4"
12"	8 5⁄8"	6"

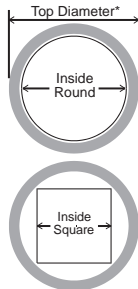

Actual lengths of the flutes for standard configurations are shown in the accompanying tables.

The extra few inches above the base allow the installer to adjust heights as needed to accommodate the variations in porch heights and slopes.

Custom flute lengths are available upon request, for the same price as standard fluted columns. Fluting typically ends 4" from the base on custom fluted columns. If using standard height columns with custom height columns, it is best to order the standard height columns custom fluted as well to match the 4" bottom spacing.



## POLYURETHANE CAP AND BASE

Column nominal diameter *	Tapered & Non-tapered Polyurethane Base					Tapered Polyurethane Cap					Non-tapered Polyurethane Cap				
	Plinth		Base round		Base height	Cap round		Abacus		Cap height	Cap Round		Abacus		Cap height
	A	B	C	D		E	F	G	H		I	J	K	L	
6"	8 1/8"	1 1/16"	6 1/8"	1 1/16"	2 7/8"	5 1/8"	1 3/16"	6 3/4"	1 1/4"	2 1/16"	6 1/8"	1 1/16"	8 1/8"	1 1/16"	2 7/8"
8"	10"	1 1/16"	8"	1 1/16"	2 7/8"	6 3/4"	1 3/16"	8 3/4"	1 1/4"	2 1/16"	8"	1 1/16"	10"	1 1/16"	2 7/8"
10"	12"	1 1/16"	10"	1 1/16"	2 7/8"	8 7/8"	1 1/16"	10 1/2"	1 1/16"	2 7/8"	10"	1 1/16"	12"	1 1/16"	2 7/8"
12"	14"	1 1/16"	12"	1 1/16"	2 7/8"	10 3/8"	1 1/16"	12"	1 1/16"	2 7/8"	12"	1 1/16"	14"	1 1/16"	2 7/8"

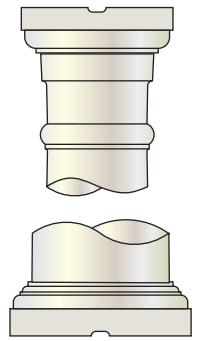
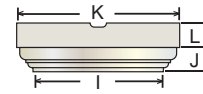
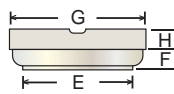
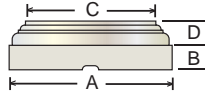

## WOOD CAP AND BASE

Column nominal diameter *	Tapered & Non-tapered Wood Base					Tapered Wood Cap					Non-tapered Wood Cap				
	Plinth		Base round		Base height	Cap round		Abacus		Cap height	Cap Round		Abacus		Cap height
	A	B	C	D		E	F	G	H		I	J	K	L	
6"	8 1/8"	1 1/2"	6 1/8"	1 1/2"	3"	5 1/8"	1 1/4"	6 3/4"	1 1/4"	2 1/2"	6 1/8"	1 1/2"	8 1/8"	1 1/2"	3"
8"	10"	1 1/2"	8"	1 1/2"	3"	6 3/4"	1 1/4"	8 3/4"	1 1/4"	2 1/2"	8"	1 1/2"	10"	1 1/2"	3"
10"	12"	1 1/2"	10"	1 1/2"	3"	8 7/8"	1 1/2"	10 3/8"	1 1/2"	3"	10"	1 1/2"	12"	1 1/2"	3"
12"	14"	1 1/2"	12"	1 1/2"	3"	10 3/8"	1 1/2"	12"	1 1/2"	3"	12"	1 1/2"	14"	1 1/2"	3"

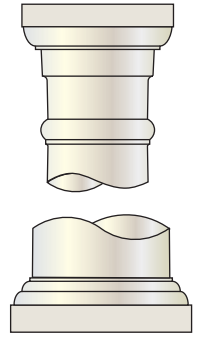
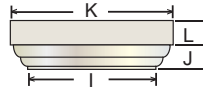
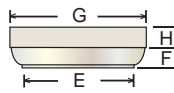
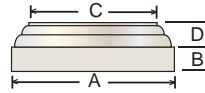

## ORNAMENTAL CAPITALS FOR ROUND TAPERED COLONIAL COLUMNS



Empire



Empire with Necking



Greek Angular Ionic



Greek Erectheum



Greek Erectheum with Necking



Modern Composite



Roman Corinthian



Roman Doric Ornamental



Roman Ionic



Scamozzi



Temple of Winds

Nominal bottom diameter	Empire				Empire with Necking				Greek Angular Ionic			
	Capital height	Abacus width	Scroll width	Height adjust	Capital height	Abacus width	Scroll width	Height adjust	Capital height	Abacus width	Scroll width	Height adjust
6"	2 1/2"	7 1/2"	6 3/4"	-4 3/8"	5"	7 1/2"	6 3/4"	-1 1/4"	2 3/4"	7 1/2"	6 3/4"	-4 1/8"
8"	3 3/4"	10"	9"	-3 1/8"	7 3/4"	10"	9"	+1 1/2"	3 5/8"	9 1/4"	9"	-3 1/4"
10"	5 1/4"	13 1/2"	12 1/4"	-2"	10"	13 1/2"	12 1/4"	+3 3/8"	5 1/8"	14 1/4"	13 3/4"	-2 1/8"
12"	6 1/4"	18"	17"	-1"	11"	18"	17"	+4 3/8"	6"	17 1/4"	17"	-1 1/4"

Nominal bottom diameter	Greek Erectheum				Greek Erectheum with Necking				Modern Composite		
	Capital height	Abacus width	Scroll width	Height adjust	Capital height	Abacus width	Scroll width	Height adjust	Capital height	Abacus width	Height adjust
6"	3 1/4"	6 3/4"	8 1/2"	-3 5/8"	n/a				6 1/2"	7 1/2"	+1/4"
8"	3 3/4"	7 3/4"	11 3/4"	-3 1/8"	5 3/4"	7 3/4"	11 3/4"	-1/2"	8 1/2"	10 3/4"	+2 1/4"
10"	5 1/4"	10 1/2"	15"	-2"	7 1/2"	10 1/2"	15"	+7/8"	11 1/2"	16 1/2"	+4 7/8"
12"	6 1/4"	14 1/2"	21"	-1"	8 1/2"	12"	17 1/4"	+1 7/8"	12 1/4"	16 1/2"	+5 5/8"

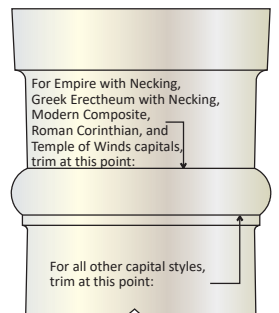

Nominal bottom diameter	Roman Corinthian			Roman Doric Ornamental			Roman Ionic				Scamozzi				Temple of Winds		
	Capital height	Abacus width	Height adjust	Capital height	Abacus width	Height adjust	Capital height	Abacus width	Scroll width	Height adjust	Capital height	Abacus width	Scroll width	Height adjust	Capital height	Abacus width	Height adjust
6"	5 3/4"	8"	-1/2"	4"	8 3/4"	-2 1/4"	2 1/4"	6 1/8"	8 1/16"	-4 5/8"	2 1/2"	6 1/2"	5 1/4"	-4 3/8"	6"	6"	-1/4"
8"	8 1/2"	12"	+2 1/4"	4 1/2"	10 1/2"	-1 3/4"	3"	8 1/4"	10 1/2"	-3 7/8"	2 7/8"	10"	8"	-4"	7"	8"	+3/4"
10"	11"	13"	+4 3/8"	6"	14 1/4"	-5/8"	3 5/8"	10 1/2"	13 1/2"	-3 3/8"	3 1/2"	11"	9 3/8"	-3 3/4"	10"	13 7/8"	+3 3/8"
12"	13 7/8"	17 3/4"	+7 1/4"	7"	16 1/4"	+3/8"	4 1/2"	12 1/2"	16 1/2"	-2 3/4"	4 7/8"	16 3/4"	14"	-2 3/8"	11 5/8"	16 7/8"	+5"