

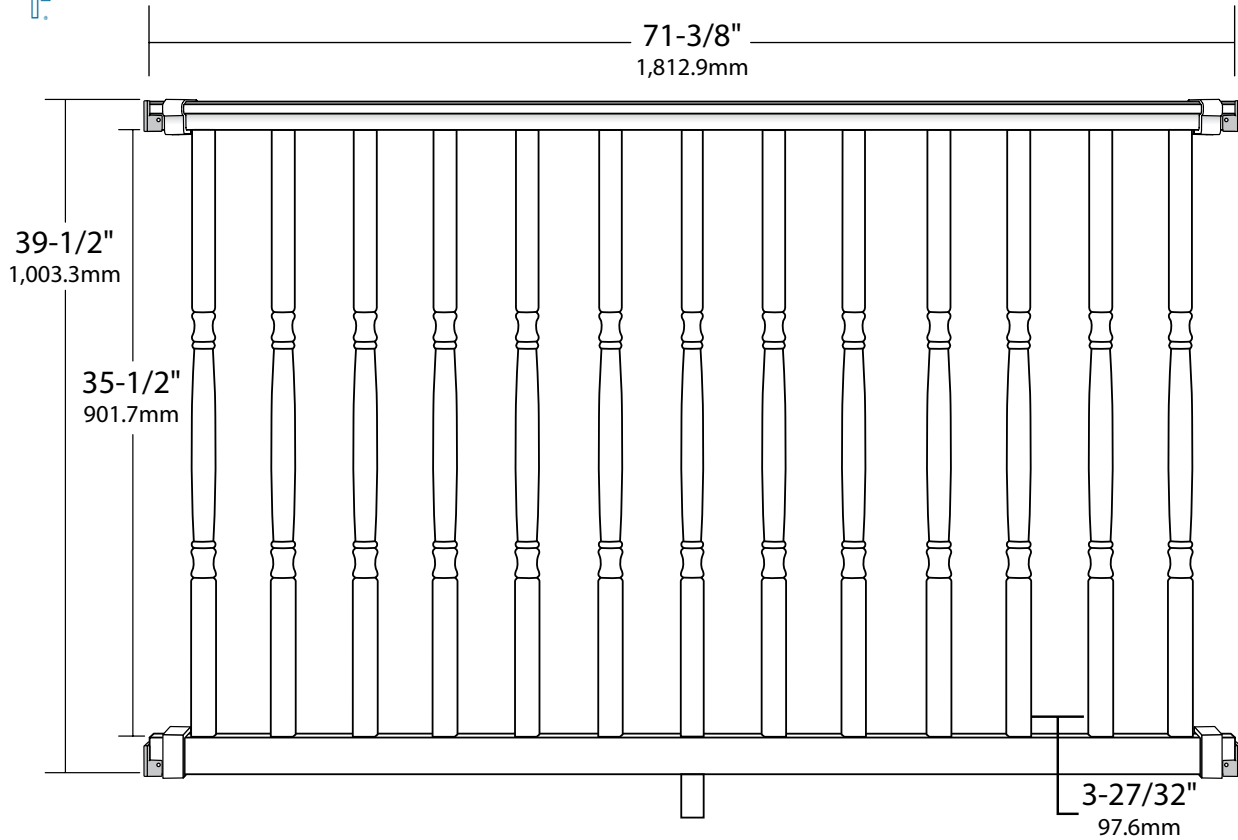

# VINYL RAILING

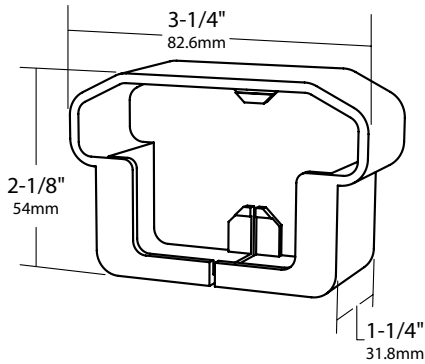

**Top Rail Bracket Cover**



**Top Rail Cutaway**

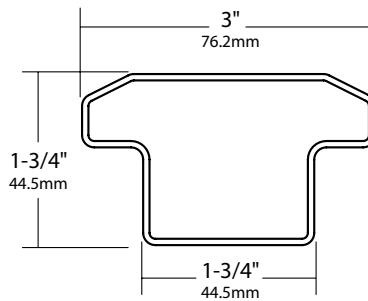

**Bottom Rail Cutaway**

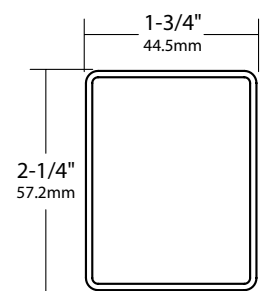

**1-3/8" x 1-3/8" x 38-1/2"**  
34.9mm 34.9mm 977.9mm  
**Turned Baluster**

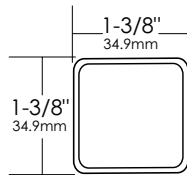

**Bottom Rail Bracket Cover**

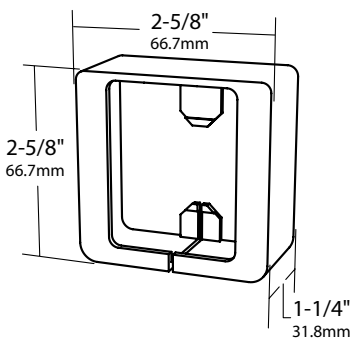

**Die Cast Mounting Bracket**  
(Same Bracket for Both Top & Bottom Rail)

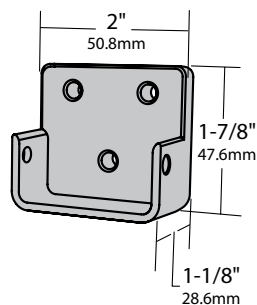

**Top Rail Aluminum Insert**

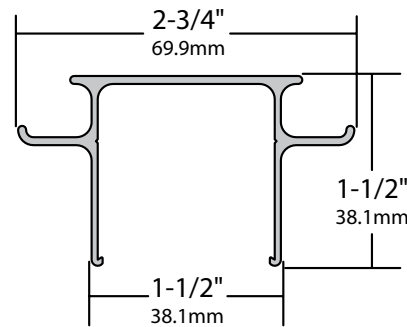

**Bottom Rail Aluminum Insert**

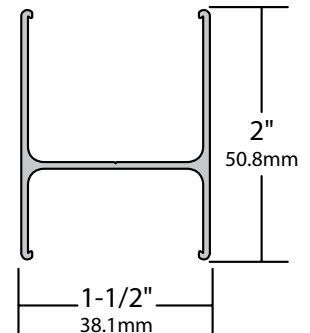

Dimensions and tolerances contained on drawings and figures are for reference only and may not encompass total allowable and approved dimensional variations.

DOCUMENT TITLE:		6' Level Vinyl Rail Kit w/Turned Balusters (42" Rail Height)			
This drawing is the property of Fairway Vinyl Systems. Any hard copy of this drawing may not be current.		V110			
This document and/or images contained within may not be reproduced in publication format without express written consent of Fairway Vinyl Systems. Drawings may not be to scale.		P.O. Box 37 Mount Joy, Pa 17552			
SCALE	SHEET#	REF#	DATE	REV	
	1 of 1	400600 & 400601	2/22/10		
		DRAWN BY	DATE		
		AH	2/22/10		



# VINYL RAILING

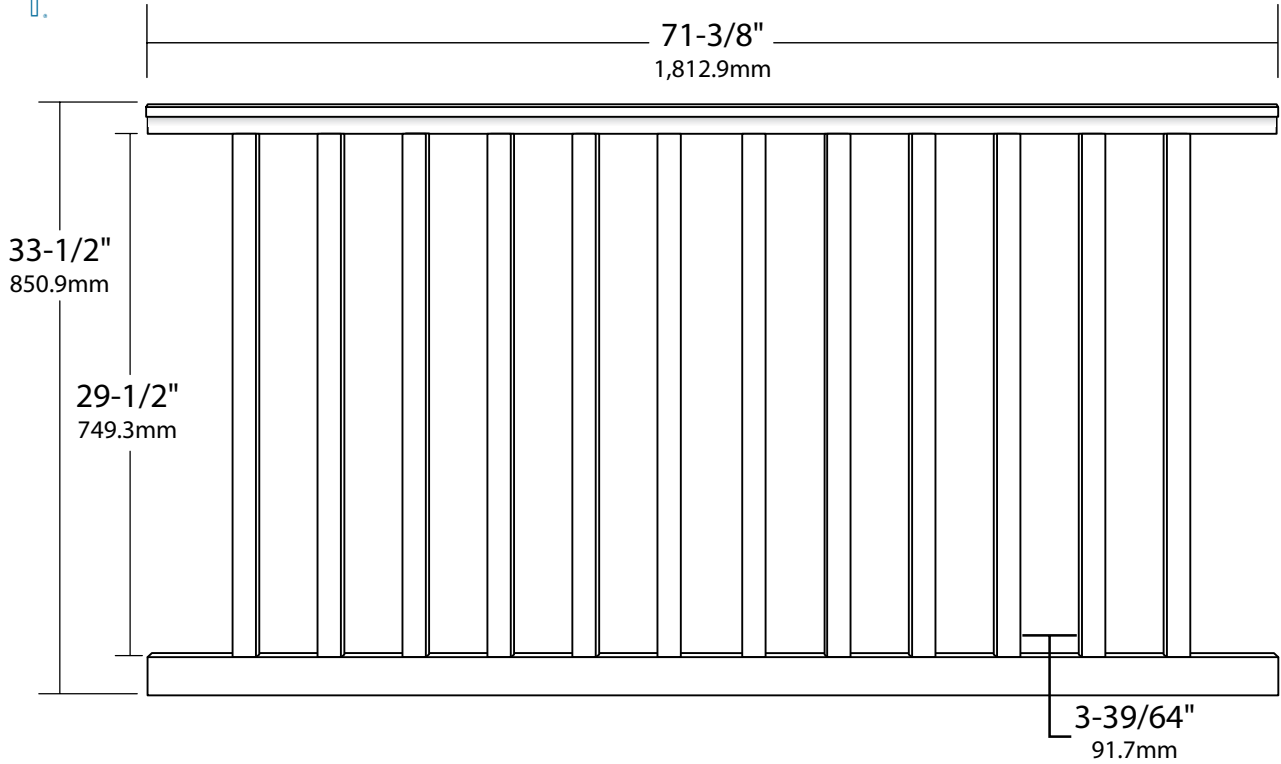

**Top Rail Stair Bracket**  
(Top of Stair Run)

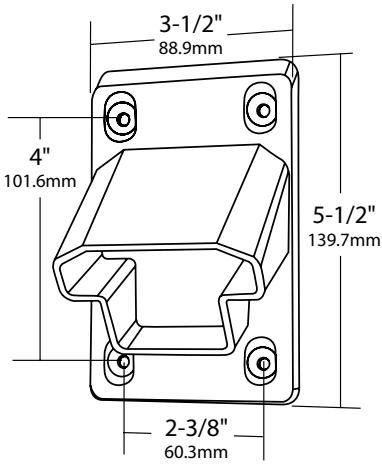

**Bottom Rail Stair Bracket**  
(Same Bracket for Both Top & Bottom)

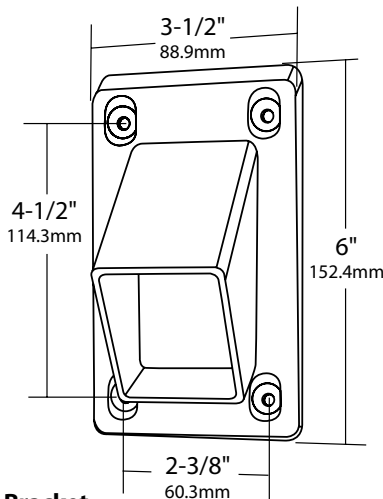

**Top Rail Stair Bracket**  
(Bottom of Stair Run)

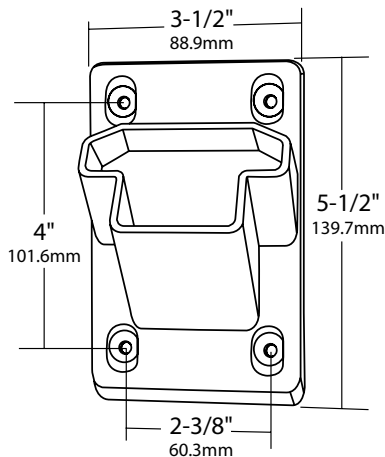

**Top Rail Cutaway**

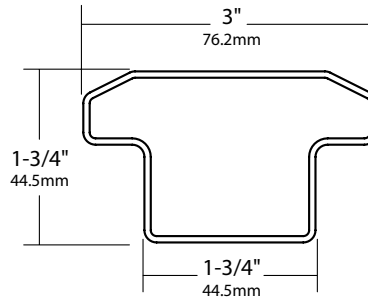

**Bottom Rail Cutaway**

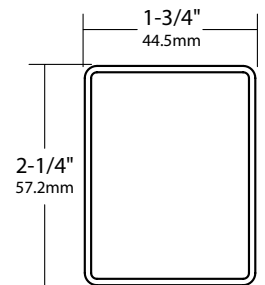

**1-3/8" x 1-3/8" x 32-1/2"**  
34.9mm 34.9mm 825.5mm

**Square Baluster**

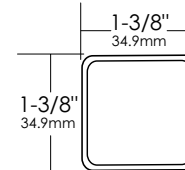

**Top Rail Aluminum Insert**

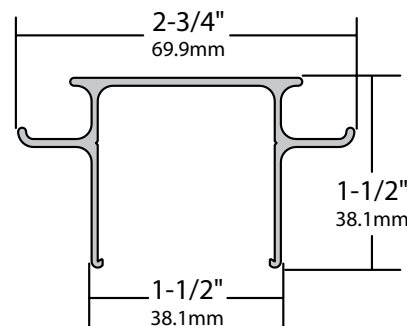

**Bottom Rail Aluminum Insert**

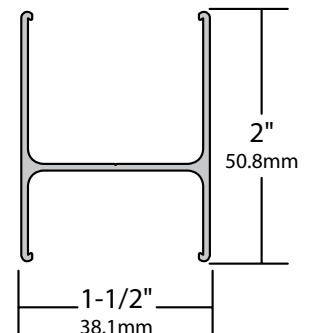

Dimensions and tolerances contained on drawings and figures are for reference only and may not encompass total allowable and approved dimensional variations.

DOCUMENT TITLE:		6' Stair Vinyl Rail Kit w/Square Balusters (36" Rail Height)			
This drawing is the property of Fairway Vinyl Systems. Any hard copy of this drawing may not be current.		V110			
This document and or images contained within may not be reproduced in publication format without express written consent of Fairway Vinyl Systems. Drawings may not be to scale.		P.O. Box 37 Mount Joy, Pa 17552			
SCALE	SHEET#	REF#	DATE	REV	
	1 of 1	400640 & 400641	2/22/10		

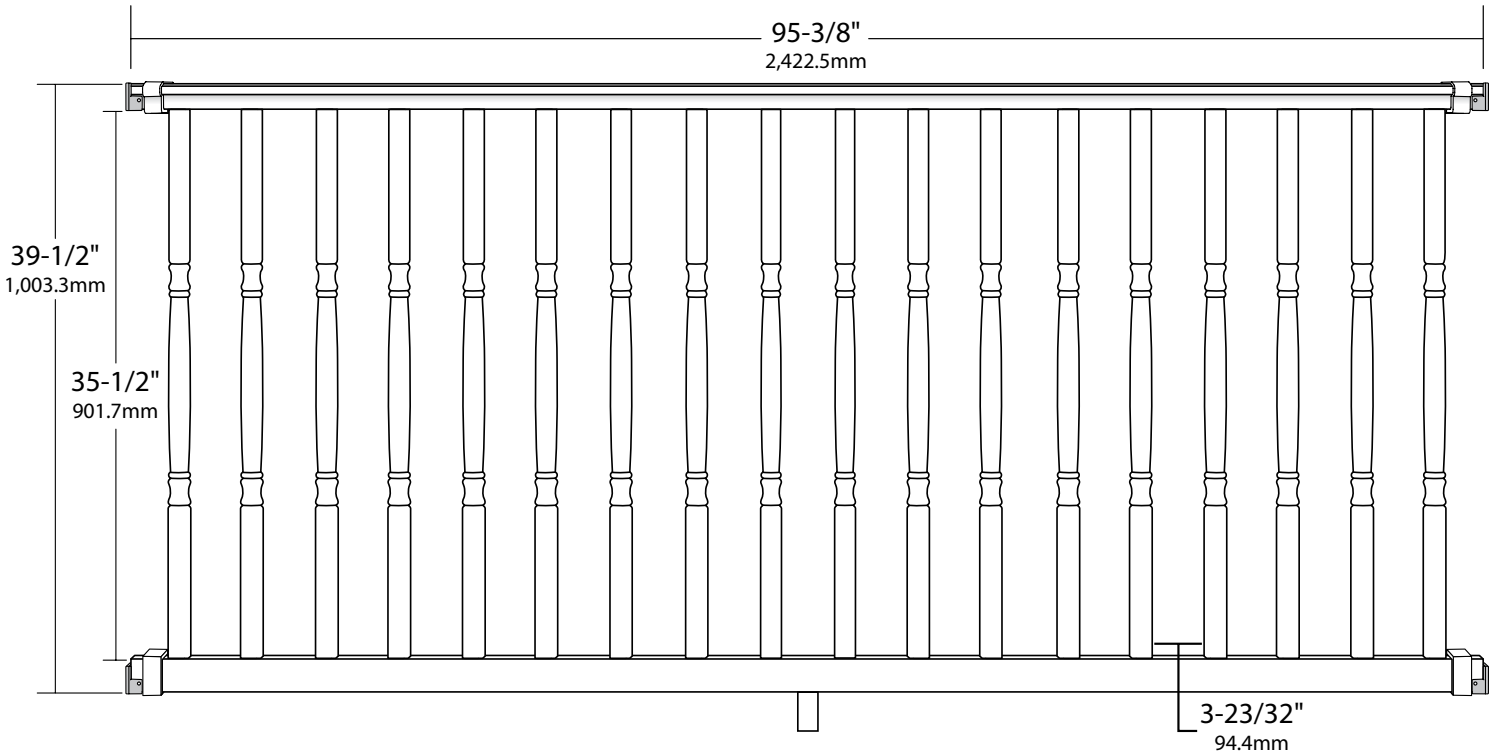

**Top Rail Bracket Cover**

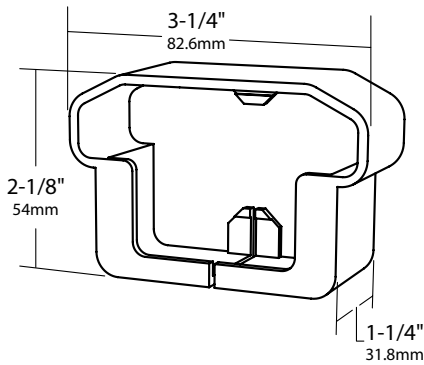

**Top Rail Cutaway**

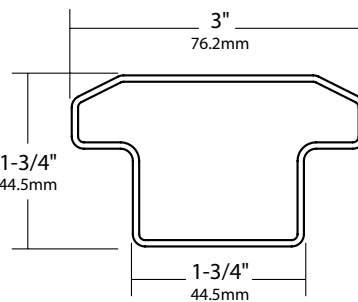

**Bottom Rail Cutaway**

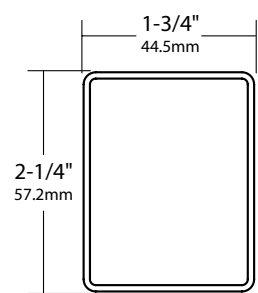

**1-3/8" x 1-3/8" x 38-1/2"**  
34.9mm 34.9mm 977.9mm  
**Turned Baluster**

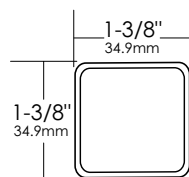

**Bottom Rail Bracket Cover**

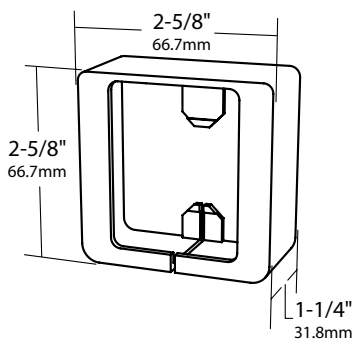

**Die Cast Mounting Bracket**  
(Same Bracket for Both Top & Bottom Rail)

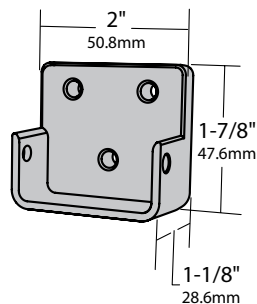

**Top Rail Aluminum Insert**

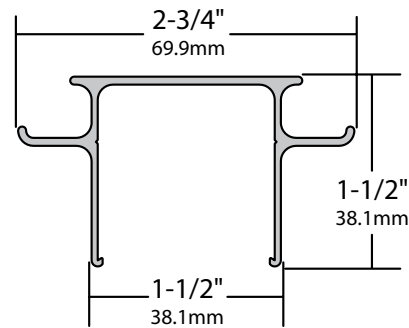

**Bottom Rail Aluminum Insert**

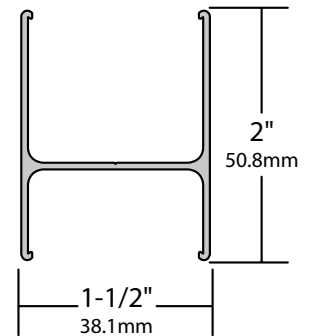

Dimensions and tolerances contained on drawings and figures are for reference only and may not encompass total allowable and approved dimensional variations.

DOCUMENT TITLE:		8' Level Vinyl Rail Kit w/Turned Balusters (42" Rail Height)			
This drawing is the property of Fairway Vinyl Systems. Any hard copy of this drawing may not be current.		V110			
This document and/or images contained within may not be reproduced in publication format without express written consent of Fairway Vinyl Systems. Drawings may not be to scale.		P.O. Box 37 Mount Joy, Pa 17552			
UOM inch/mm	REF#	400604 & 400605	REV		
SCALE	SHEET#	1 of 1	DRAWN BY	DATE	2/22/10

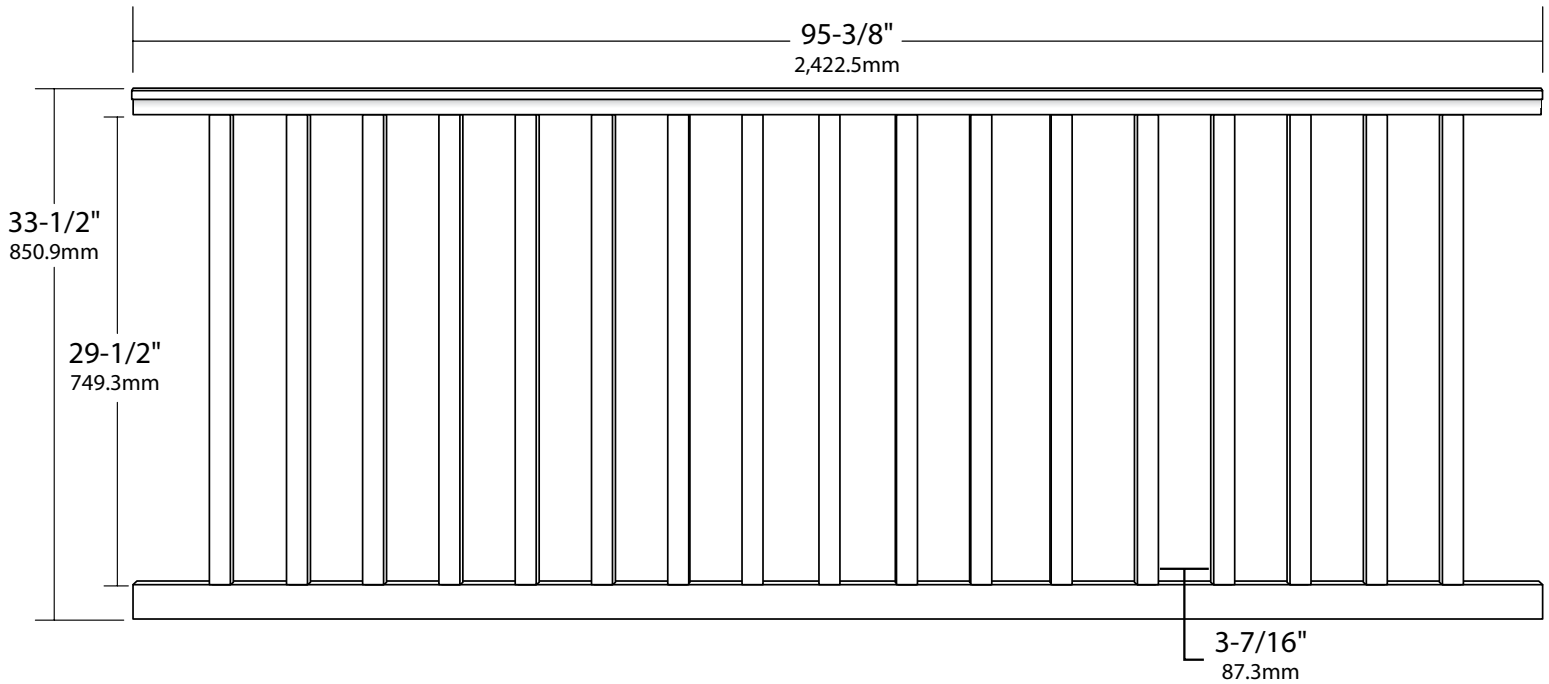

**Top Rail Stair Bracket**  
(Top of Stair Run)

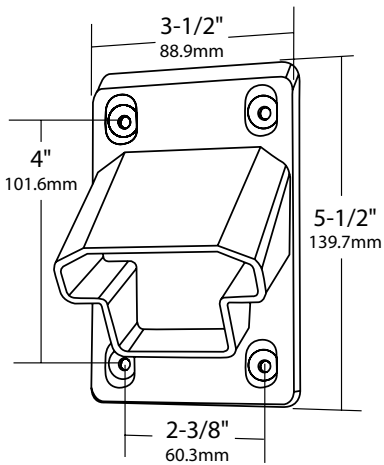

**Bottom Rail Stair Bracket**  
(Same Bracket for Both Top & Bottom)

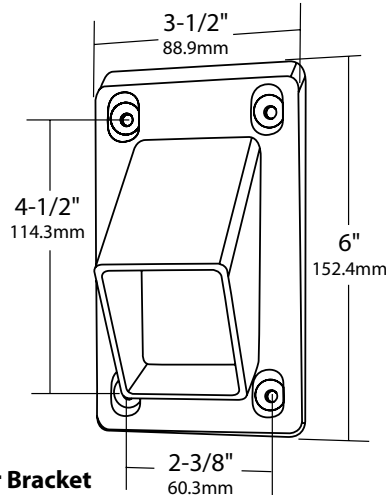

**Top Rail Stair Bracket**  
(Bottom of Stair Run)

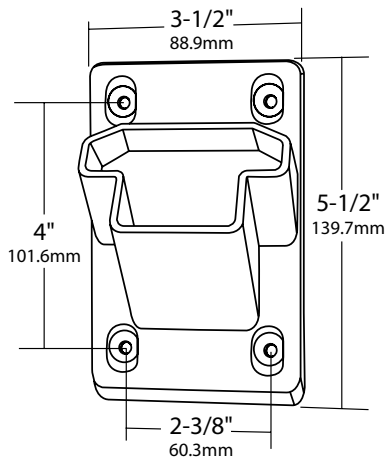

**Top Rail Cutaway**

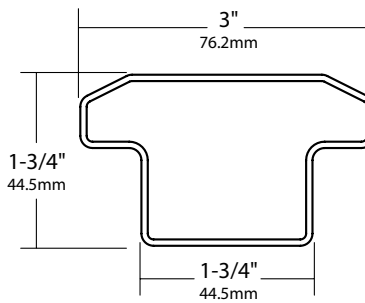

**Bottom Rail Cutaway**

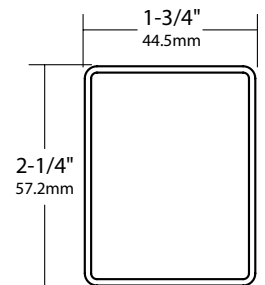

**1-3/8" x 1-3/8" x 32-1/2"**  
34.9mm 34.9mm 825.5mm

**Square Baluster**

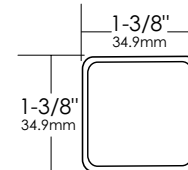

**Top Rail Aluminum Insert**

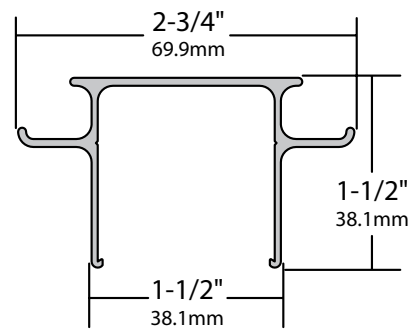

**Bottom Rail Aluminum Insert**

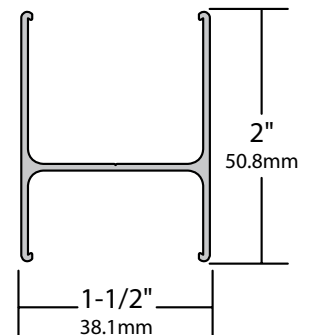

Dimensions and tolerances contained on drawings and figures are for reference only and may not encompass total allowable and approved dimensional variations.

DOCUMENT TITLE:		8' Stair Vinyl Rail Kit w/Square Balusters (36" Rail Height)			
This drawing is the property of Fairway Vinyl Systems. Any hard copy of this drawing may not be current.		V110			
This document and/or images contained within may not be reproduced in publication format without express written consent of Fairway Vinyl Systems. Drawings may not be to scale.		P.O. Box 37 Mount Joy, Pa 17552			
SCALE	SHEET#	REF#	DATE	DRAWN BY	REV
	1 of 1	400645 & 400646	2/22/10	AM	

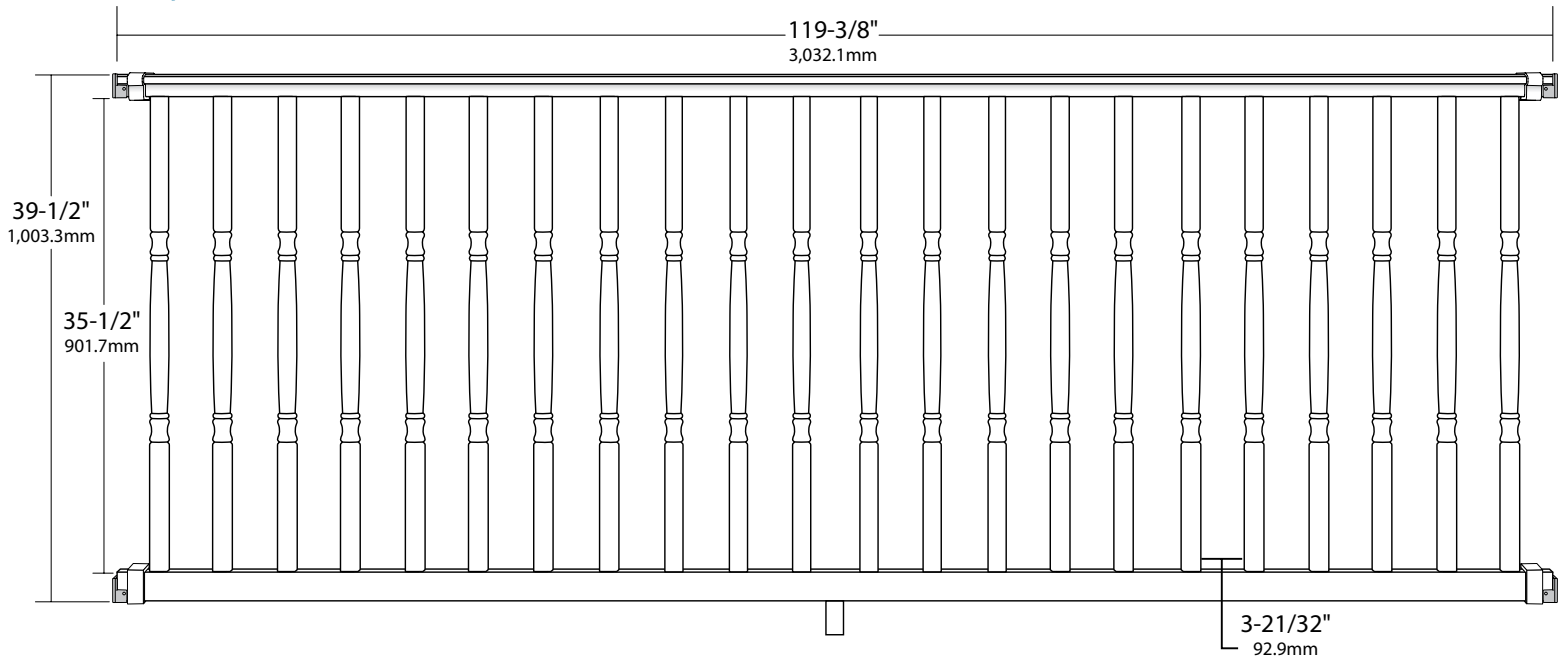

**Top Rail Bracket Cover**

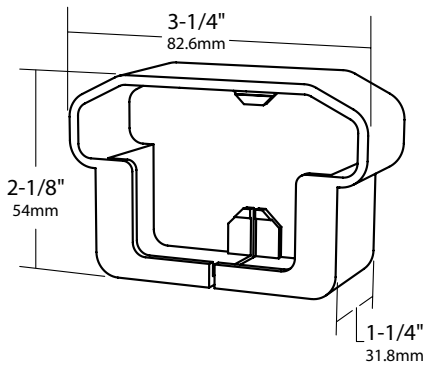

**Top Rail Cutaway**

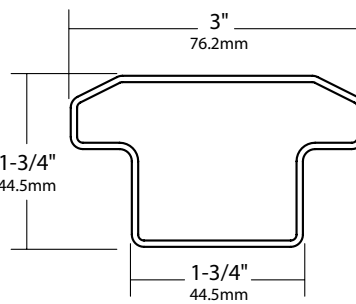

**Bottom Rail Cutaway**

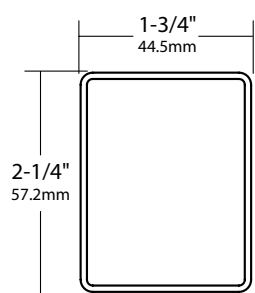

**1-3/8" x 1-3/8" x 38-1/2"**  
34.9mm 34.9mm 977.9mm

**Turned Baluster**

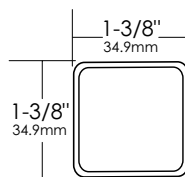

**Bottom Rail Bracket Cover**

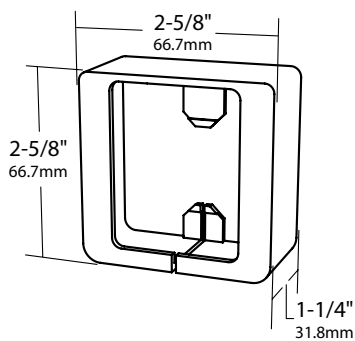

**Top Rail Aluminum Insert**

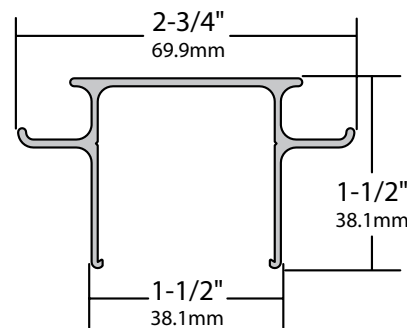

**Bottom Rail Aluminum Insert**

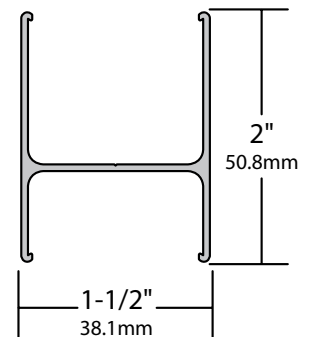

**Die Cast Mounting Bracket**  
(Same Bracket for Both Top & Bottom Rail)

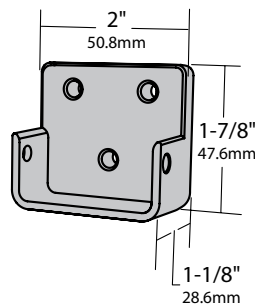

Dimensions and tolerances contained on drawings and figures are for reference only and may not encompass total allowable and approved dimensional variations.

DOCUMENT TITLE:		10' Level Vinyl Rail Kit w/Turned Balusters (42" Rail Height)			
This drawing is the property of Fairway Vinyl Systems. Any hard copy of this drawing may not be current.		V110			
This document and/or images contained within may not be reproduced in publication format without express written consent of Fairway Vinyl Systems. Drawings may not be to scale.		P.O. Box 37 Mount Joy, Pa 17552			
SCALE	SHEET#	REV#	DATE	REV	
	1 of 1	400632 & 400633	2/18/10	AH	

## 4X - TOP RAIL BRACKET COVER

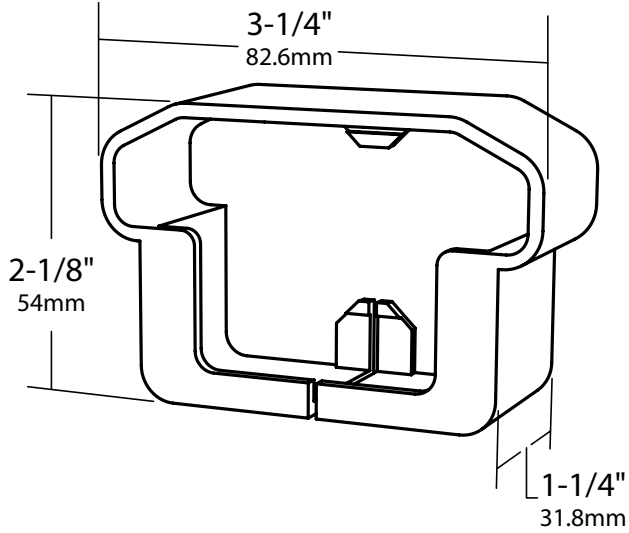

## 4X - BOTTOM RAIL BRACKET COVER

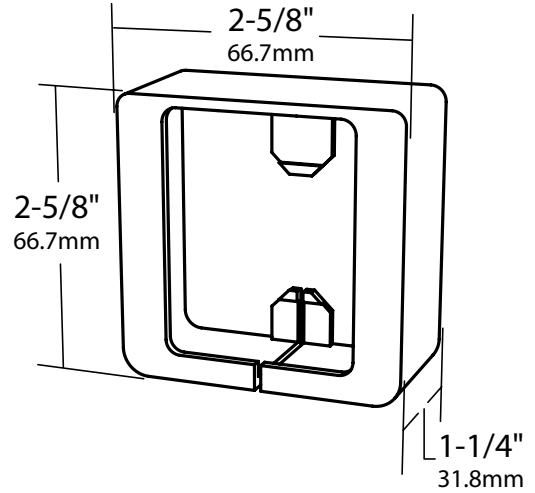

## 12X - #8 x 1-1/2\"/> Stainless Steel Screws

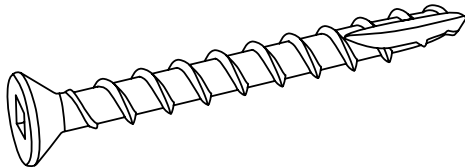

## 8X - #10 x 3/4\"/> Stainless Steel Screws

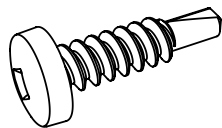

## 4X - DIE CAST MOUNTING BRACKET

(Same Bracket for Both Top & Bottom Rail)

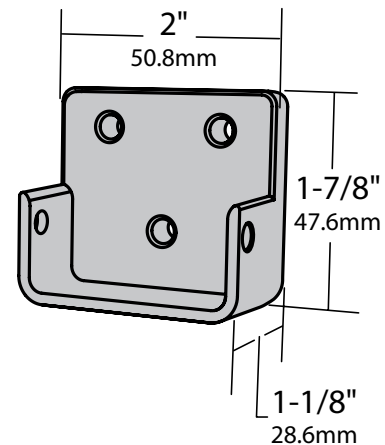

Dimensions and tolerances contained on drawings and figures are for reference only and may not encompass total allowable and approved dimensional variations.

DOCUMENT TITLE:		Vinyl Level Bracket Kit			
This drawing is the property of Fairway Vinyl Systems. Any hard copy of this drawing may not be current.		V110			
This document and or images contained within may not be reproduced in publication format without express written consent of Fairway Vinyl Systems. Drawings may not be to scale.		P.O. Box 37 Mount Joy, Pa 17552			
UOM inch/mm	REF#	400610 & 400611	REV		
SCALE	SHEET#	1 of 1	DRAWN BY	DATE	2/26/10

**Top Rail Stair Bracket**  
(Top of Stair Run)

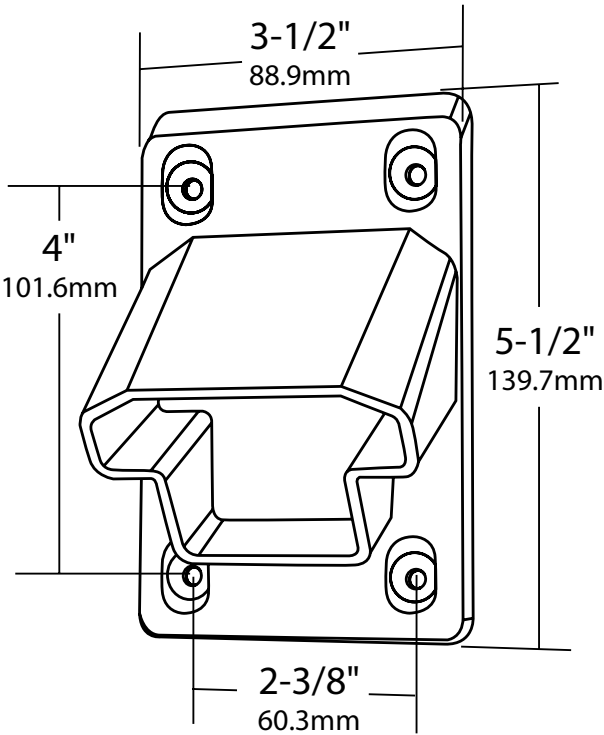

**Top Rail Stair Bracket**  
(Bottom of Stair Run)

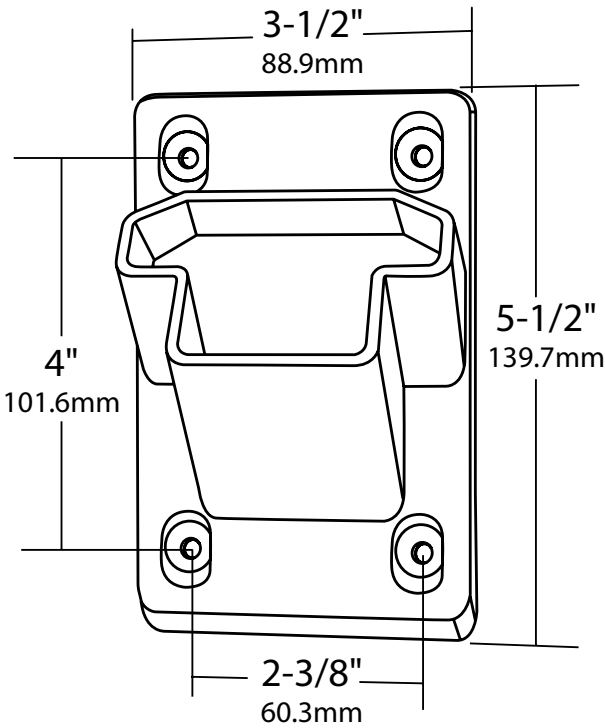

**16X - #8 x 1-1/2"**  
**Stainless Steel Screws**

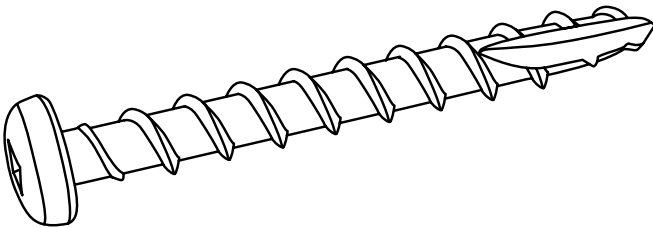

**8X - #10 x 3/4"**  
**Stainless Steel Screws**  
(Powder Coated End)

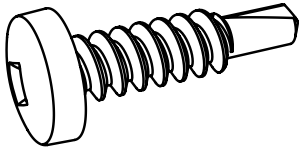

**Bottom Rail Stair Bracket**  
(Same Bracket for Both Top & Bottom)

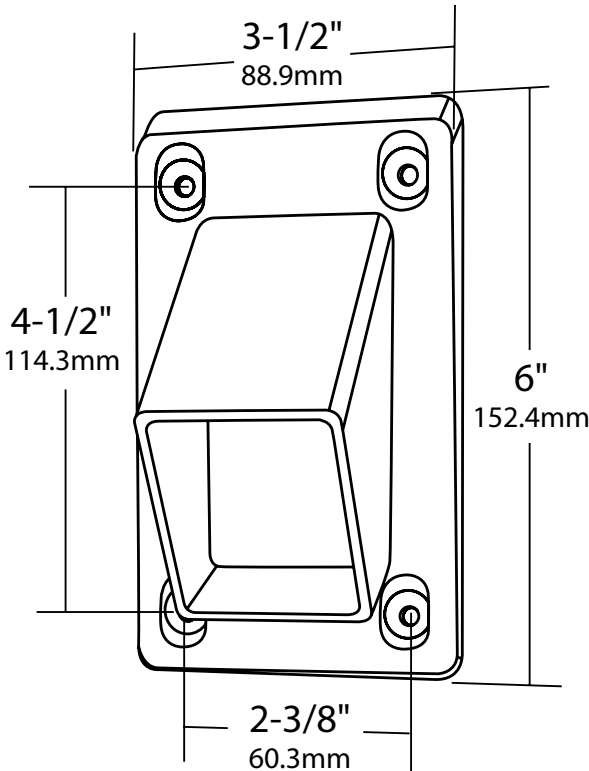

Dimensions and tolerances contained on drawings and figures are for reference only and may not encompass total allowable and approved dimensional variations.

DOCUMENT TITLE:		Vinyl Stair Bracket Kit			
This drawing is the property of Fairway Vinyl Systems. Any hard copy of this drawing may not be current.		V110			
This document and/or images contained within may not be reproduced in publication format without express written consent of Fairway Vinyl Systems. Drawings may not be to scale.		P.O. Box 37 Mount Joy, Pa 17552			
UOM	REF#	400615 & 400616	REV		
SCALE	SHEET#	1 of 1	DRAWN BY	DATE	2/26/10

**2X - TOP RAIL  
BRACKET ADAPTER**

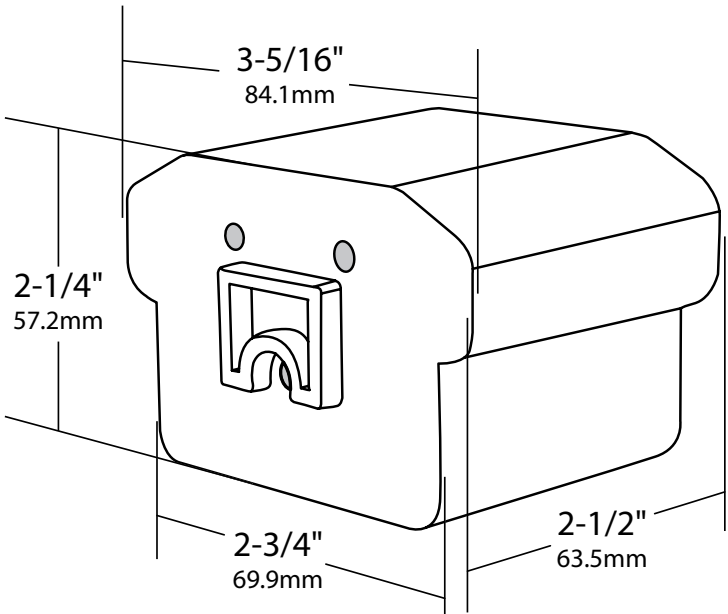

**2X - BOTTOM RAIL  
BRACKET ADAPTER**

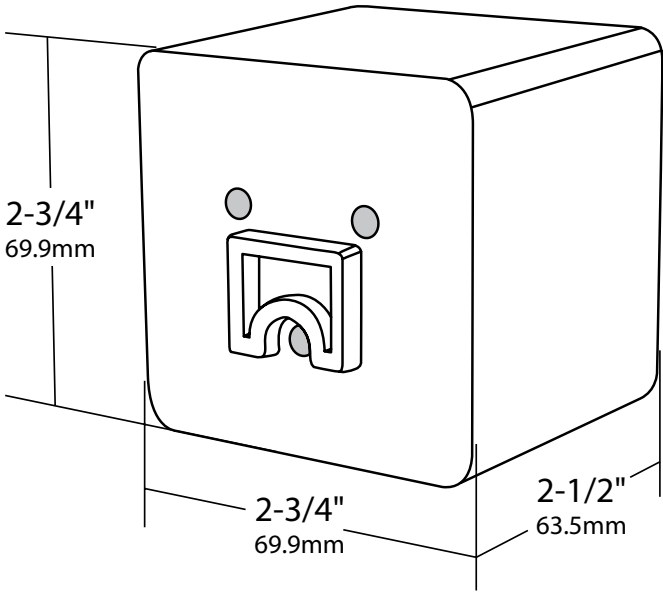

**12X - #8 x 2-1/2"  
Stainless Steel Screws**

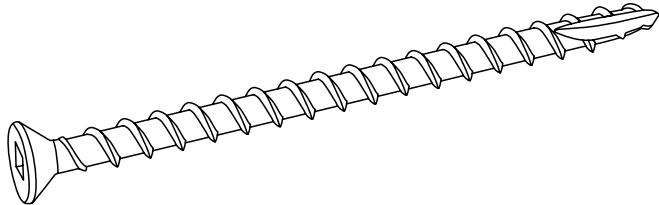

Dimensions and tolerances contained on drawings and figures are for reference only and may not encompass total allowable and approved dimensional variations.

DOCUMENT TITLE:		Vinyl Bracket Adapter Kit			
<i>This drawing is the property of Fairway Vinyl Systems. Any hard copy of this drawing may not be current. This document and or images contained within may not be reproduced in publication format without express written consent of Fairway Vinyl Systems. Drawings may not be to scale.</i>		V110			
		P.O. Box 37 Mount Joy, Pa 17552			
SCALE	SHEET#	REF#	DRAWN BY	DATE	REV
	1 of 1	400620 & 400621	AH	2/26/10	



**1-3/8" x 1-3/8" x 32-1/2"**  
**V110 Turned Baluster**

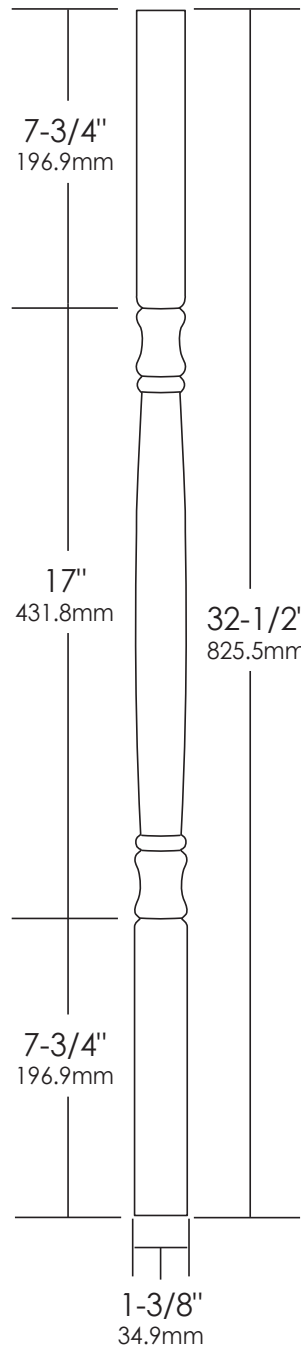

Dimensions and tolerances contained on drawings and figures are for reference only and may not encompass total allowable and approved dimensional variations.

DOCUMENT TITLE: LandMarke 1-3/8" x 1-3/8" x 32-1/2" Turned Baluster			
<i>This drawing is the property of Fairway Vinyl Systems. Any hard copy of this drawing may not be current.</i>			
<b>V110</b> <b>P.O. Box 37 Mount Joy, Pa 17552</b>			
UOM inch/mm	REF# T1303W, T1303C	REV	
SCALE	SHEET# 1 of 1	DRAWN BY AH	DATE 2/22/10

**1-3/8" x 1-3/8" x 38-1/2"**  
**V110 Turned Baluster**

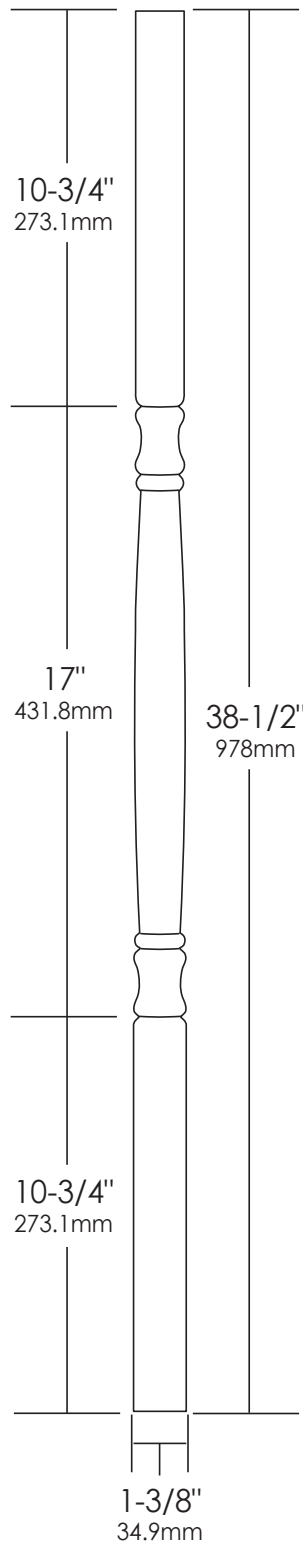

Dimensions and tolerances contained on drawings and figures are for reference only and may not encompass total allowable and approved dimensional variations.

DOCUMENT TITLE: LandMarke 1-3/8" x 1-3/8" x 38-1/2" Turned Baluster			
<i>This drawing is the property of Fairway Vinyl Systems. Any hard copy of this drawing may not be current.</i>			
<b>V110</b>			
<b>P.O. Box 37 Mount Joy, Pa 17552</b>			
UOM inch/mm	REF# T1304W, T1304C	REV	
SCALE	SHEET# 1 of 1	DRAWN BY AH	DATE 2/22/10