

Ultimate Multi Point Astragal

Outswing Field Installation Instructions



8817 West Market Street
Colfax, NC 27235 | 800.334.2006
www.enduraproducts.com

Tools Required:

- Pencil/Marker
- Utility Knife
- Tape Measure
- Drill (3/8" and 5/8" Bits)

Kit Includes:

- (2) Strike Plates
- (8) #8 x 3" Screws
- --
- (1) Outswing Bolt Receiver
- (1) Long Bolt Receiver

STEP 1: INSTALL HEADER AND SILL BOLT RECEIVERS

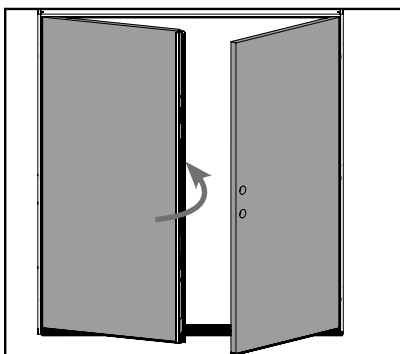

a. Close the inactive door panel until the weatherstrip on the header is compressed.

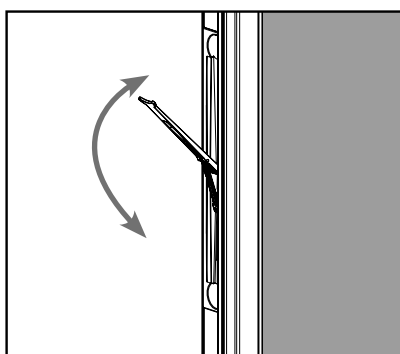

b. Engage the flip lever so the upper and lower bolt pins come in contact with the header and the sill. Mark these points of contact.

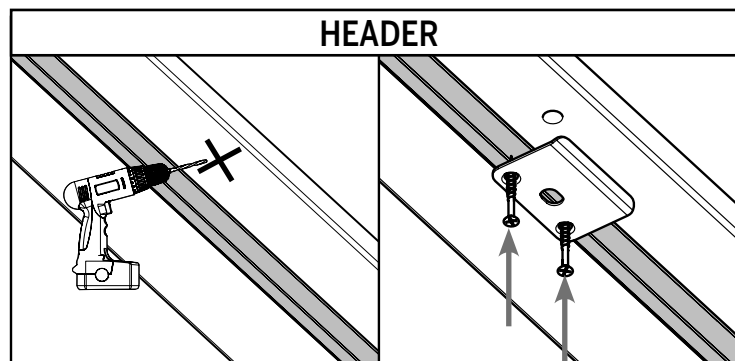
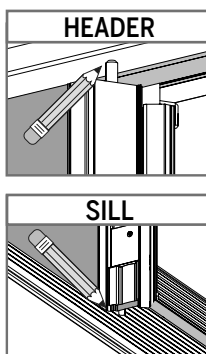

c. At the marked location on the header, drill a hole **3/8" in diameter** and at least **1-3/8" deep**. Install the header strike plate by screwing into the header, using two #8 x 3" screws.

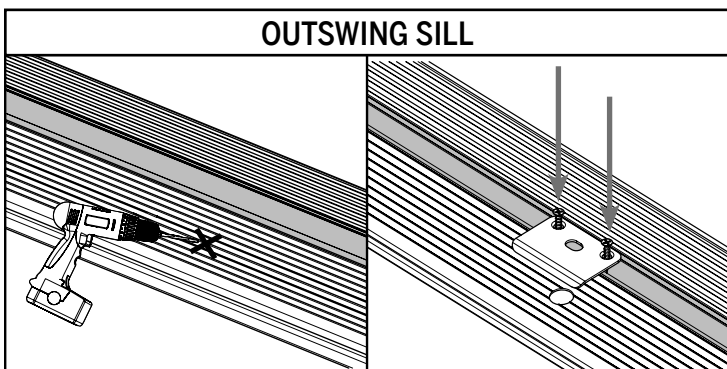

d. At the marked location on the sill, drill a hole **5/8" in diameter** and at least **1-3/8" deep**. Install the other strike plate into the sill, using two #8 x 3" screws.

Rev. Date: 6.12.2018
©Endura Products, Inc.
Innovation protected under patents and patents pending in
U.S. and Canada. See www.EnduraPatents.com.
#211159-MP-O-FP

STEP 2: CUT WEATHERSTRIP AT HEADER

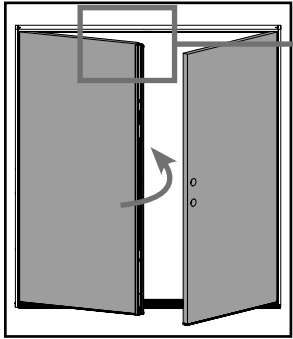

a. Close the inactive door. Make a mark at the location where the trim cap contacts the weatherstrip.

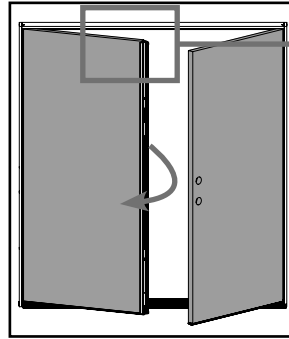
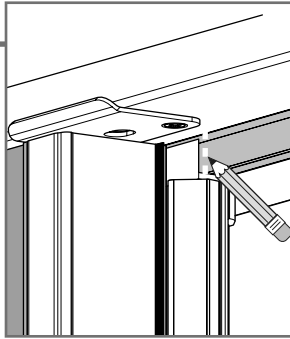

b. Open the inactive door. Using a utility knife, make a slit in the weatherstrip along the mark made.

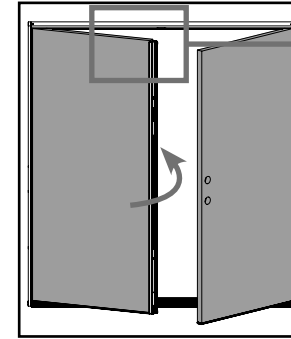
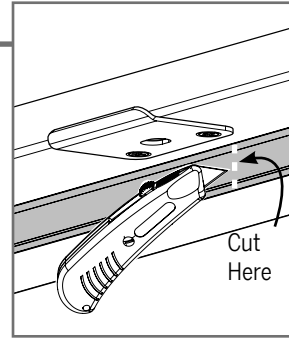

c. Close the inactive door panel. Ensure the weatherstrip forms a secure seal around the trim cap.

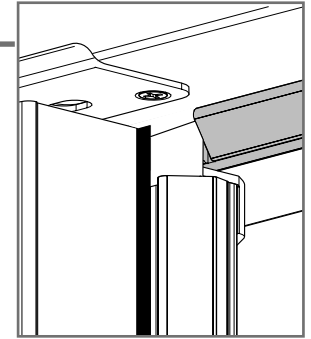

STEP 3: INSTALL STRIKE PLATE

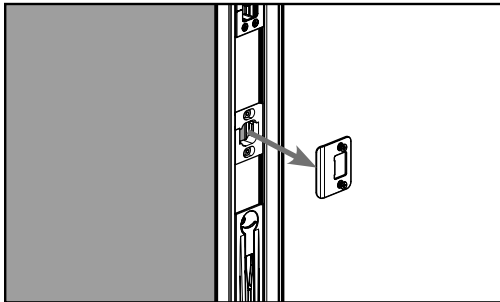

a. If installing new hardware, unscrew the securing screws and remove the old strike plates from the retainer.

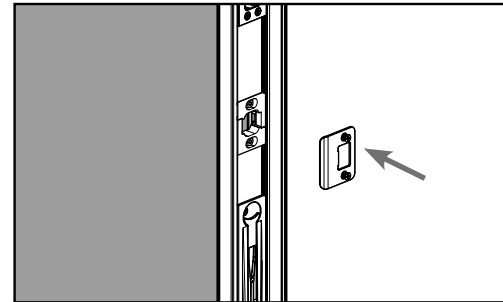

b. Install the new hardware into the retainers by tightening the screws through the holes in the new strike plate.

STEP 4: CHECK ALIGNMENT OF DEADBOLT ACTUATOR

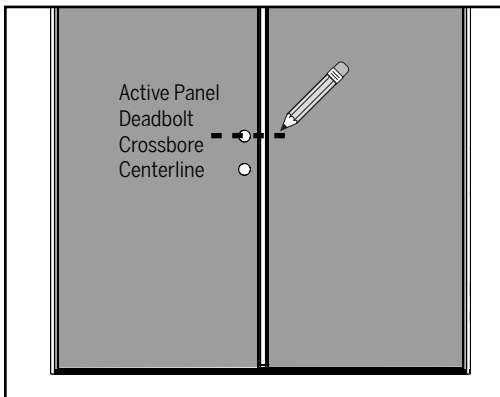

a. Determine the deadbolt crossbore centerline of the active door panel and mark this location on the inactive door.

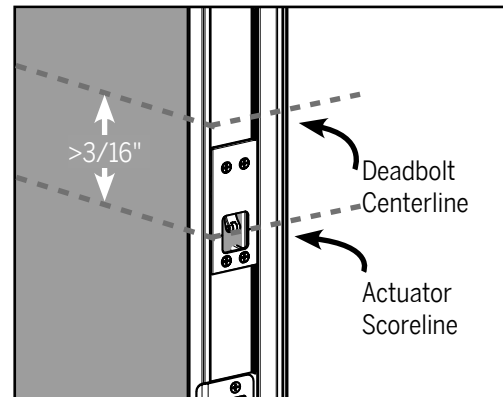

b. Check the alignment of the deadbolt actuator with the deadbolt crossbore centerline. If it is misaligned by more than 3/16", adjust the location of the deadbolt actuator as detailed in Step 5. If they are aligned, skip to Step 6.

STEP 5: ADJUST THE LOCATION OF THE DEADBOLT ACTUATOR IF MISALIGNED MORE THAN 3/16"

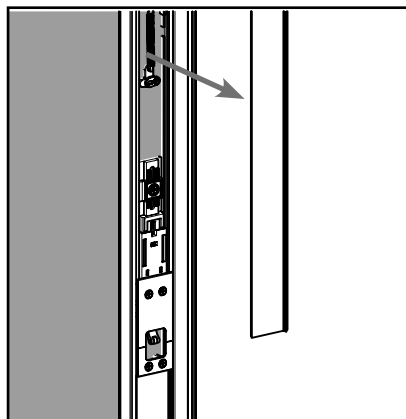
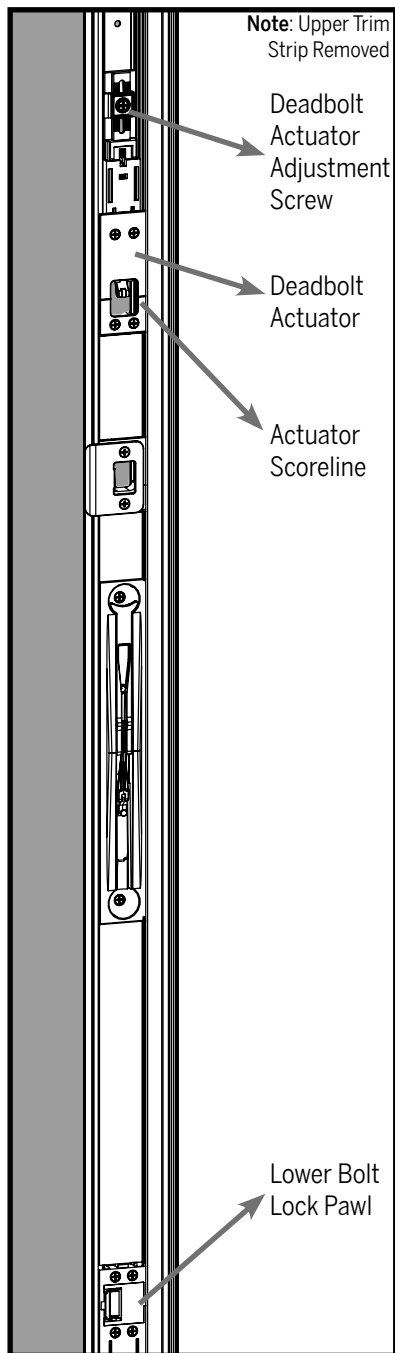

a. Remove the trim strip located right above the deadbolt actuator.

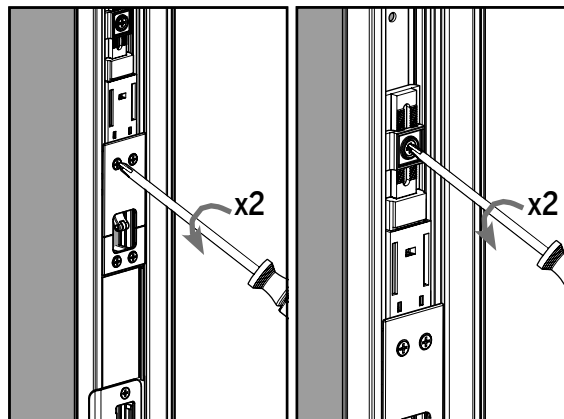

b. Loosen the four screws on the deadbolt actuator and actuator adjuster screw two turns each.

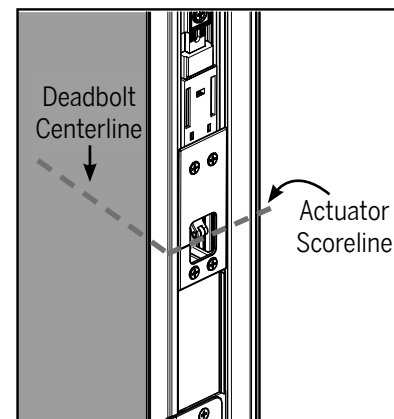

c. Adjust the location of the deadbolt actuator by moving it up or down so the actuator scoreline aligns with the deadbolt crossbore centerline.

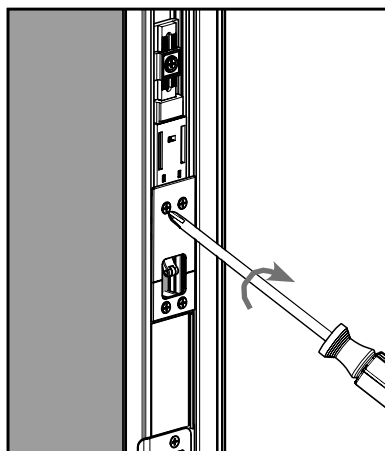

d. Tighten the four screws on the deadbolt actuator. **Do not overtighten.**

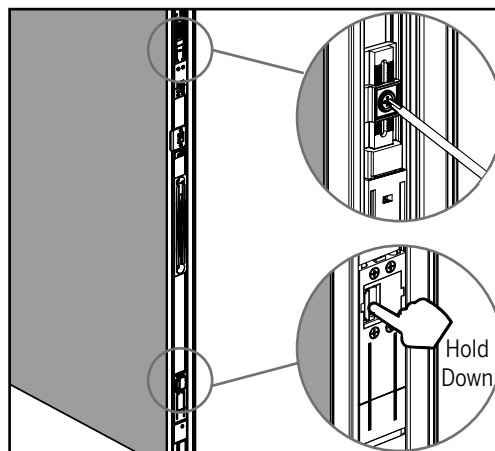

e. Hold down the lock pawl on the lower bolt and tighten the actuator adjuster screw to set the location of the deadbolt actuator.

STEP 6: CONFIRM PROPER INSTALLATION

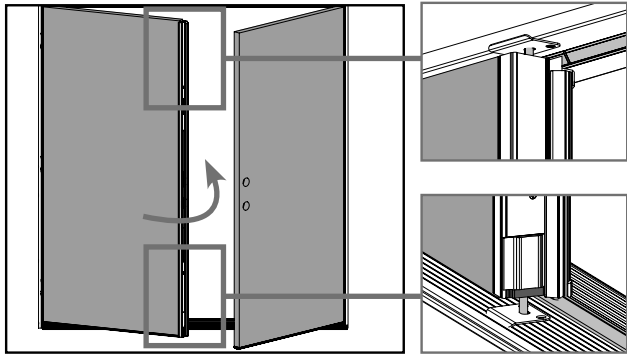

a. Close inactive door panel and engage both the upper and lower bolts to ensure they fit into the bolt receivers smoothly.

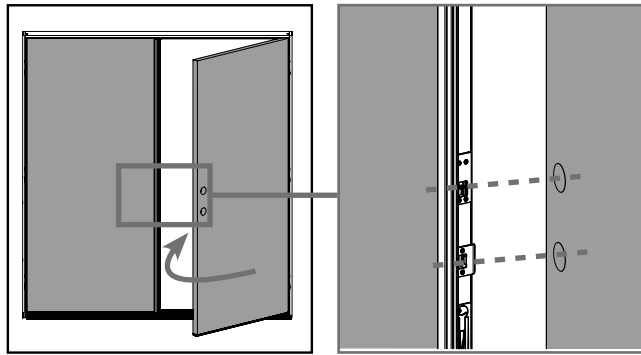

b. Close the active door panel and ensure the deadbolt actuator and strike plate are aligned with the crossbore holes in the active door panel.

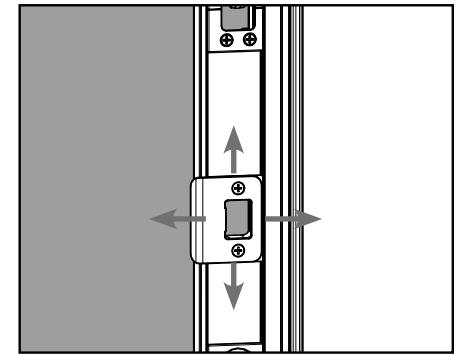

c. If the deadbolt actuator is not aligned, return to Step 4. If the strike plate is not aligned, loosen the screws and slightly adjust the location of the plate.

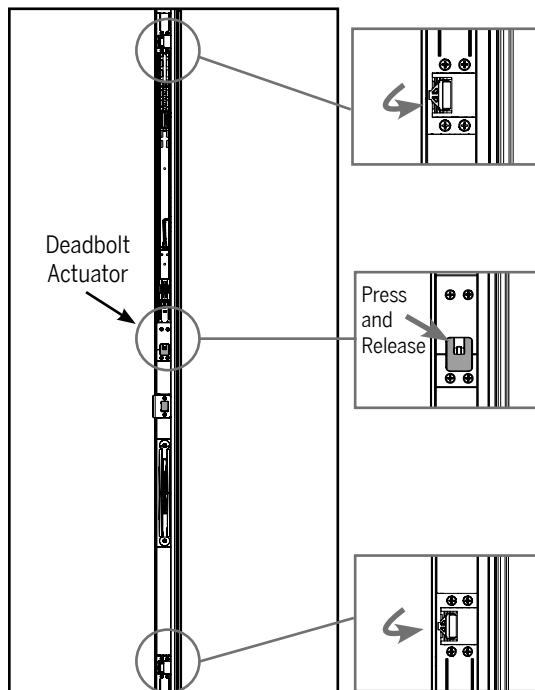

d. Press and release the deadbolt actuator and ensure that when the deadbolt actuator is depressed, the lock pawls move between engaged and disengaged positions smoothly.

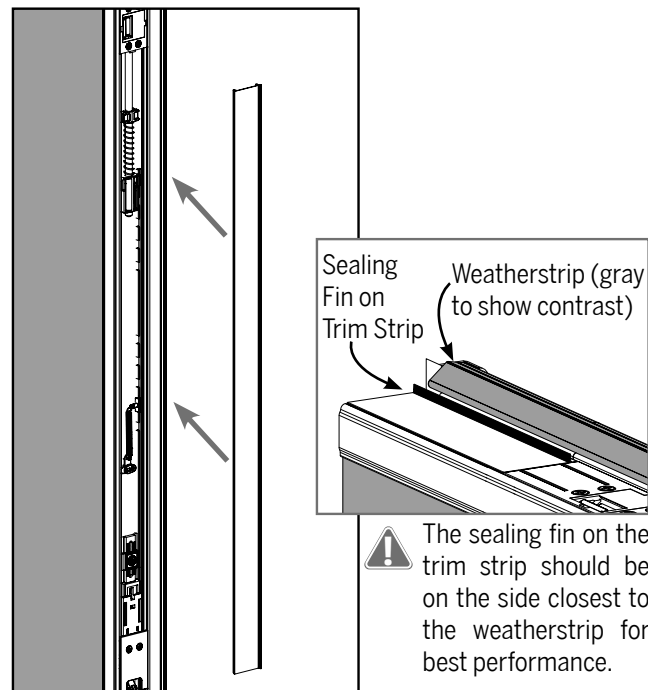

e. If the trim strip was removed, reinstall the trim strip so it is flush between the upper lock pawl housing and the deadbolt actuator. If necessary, cut off any excess trim strip.

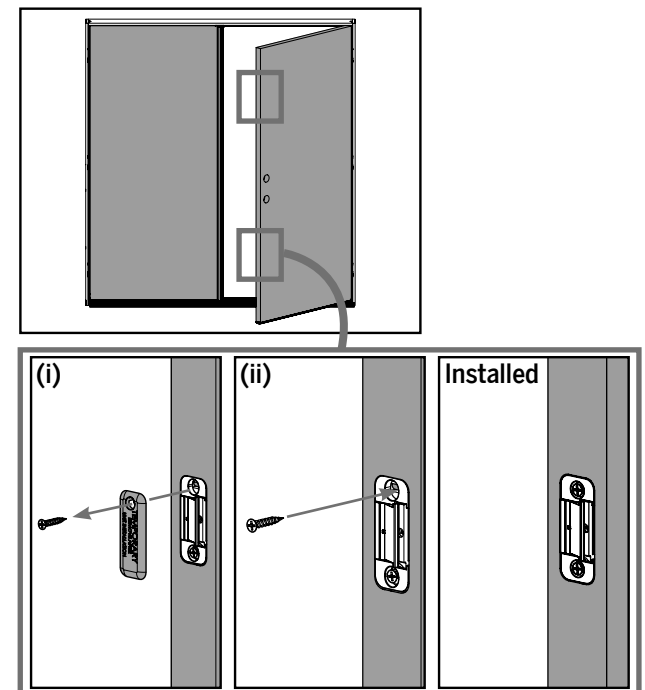

f. When painting and installation are complete, (i) remove the screw from the spacer on each keeper and remove the spacer. (ii) Reinstall the screw to secure it in place.