

Phoenix 5200 Series

The outstanding choice for beauty and safety

5200 Series
25 Gauge (.019" min)
2" Sections



Beauty, Choice, Safety

The Hörmann Phoenix Collection offers custom-designed beauty and unsurpassed safety, by pairing unique carriage house door styles with our FingerGuard™ pinch-resistant joints. The virtually maintenance-free Phoenix Collection doors feature a tough steel front and back with polystyrene core, giving an R value of 6.9. A wide range of custom designs is available to complement your home.

Deep tongue and groove section joint contribute to the door's **excellent strength**. Intermediate seals prevent air infiltration, which enhances the **insulation** properties.

The steel front and back 3-layer sandwich construction with **insulating polystyrene core** increases energy savings and provides a very smooth and quiet door operation.

Carriage house inlay designs in both **semi-custom and custom configurations** with easy to clean **Rainslope™** woodgrain texture, galvanized and **finish painted steel** provide years of trouble-free performance and beauty.

The bottom weather seal **keeps out wind, rain, debris and other elements** for added energy savings.

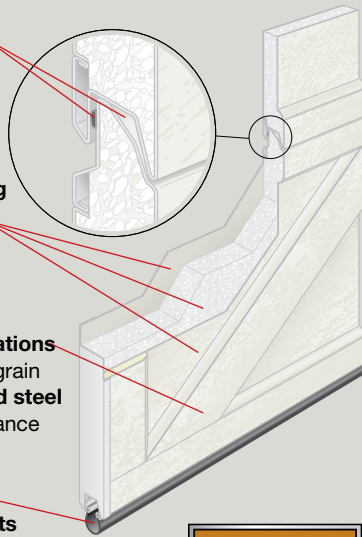

*Ask your dealer for details

Hörmann Exclusive

FingerGuard™ Pinch Resistant



The FingerGuard™ section joint and hinges provide air-tight seal and prevent finger injuries inside and outside.

White 11 Ball Bearing Nylon Rollers

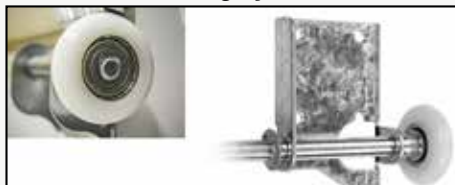

Hörmann nylon rollers feature 11 pre-lubed ball bearings encased in a high strength steel casing that provides a quiet ride and years of reliable service.

Between Section & Side Seals



Factory installed between section weather seal and side seal offer maximum protection from the outside elements while further enhancing the insulation properties of a door.

Choose your own design

*More designs available

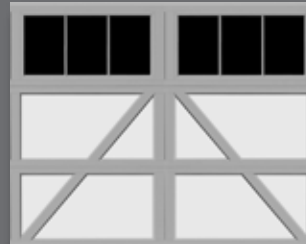

Scottsdale
with glazed 3 pane windows

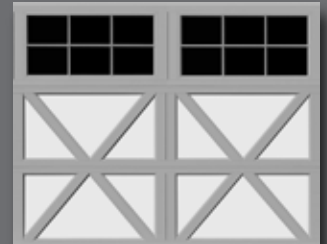

Glendale
with glazed 6 pane windows



Gilbert
with glazed 6 pane windows



Mesa I*
with glazed arch 3 pane windows

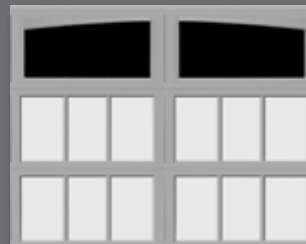

Chandler II*
with solid arch 1 pane windows

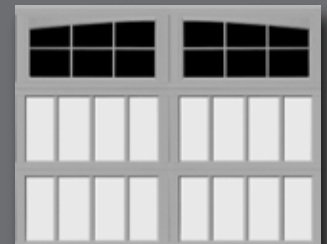

Tempe II*
with glazed arch 6 pane windows

Ready for your personal touch

Hörmann's exclusive Galaxy Paint System is available to further customize your new Phoenix door with 28 semi-custom colors or unlimited color matching capabilities.



With Hörmann Galaxy Paint System, you will not only be confident that you have purchased the highest quality and safest garage door for your home but one that will match the color of its exterior with a factory finish that will last.

Specifications

Series	Phoenix 5200
Steel Thickness	25 ga.
Section Thickness	2 in.
R - Value	6.9
Polystyrene Core Insulation	Standard

Panel Designs	
Scottsdale	Standard
Glendale	Standard
Gilbert	Standard
Mesa I & II	Standard
Chandler I & II	Standard
Tempe I & II	Standard

Available Colors	
White	Standard
Galaxy Paint System	Optional

Warranty	
Sections	Limited Lifetime
Hardware	10 years
Springs	10 years

Please call us at 1-877-OK-HORMANN (1-877-654-6762) for more details.

SilentDrive®

The advanced technology in SilentDrive® garage door openers provide:

- Ultra quiet performance
- Unique safety features
- Maximum convenience



Select your favorite window design



Glazed 1 pane



Glazed arch 1 pane



Glazed 3 pane



Glazed arch 3 pane



Glazed 6 pane



Glazed arch 6 pane

Non-insulated and insulated glass is available along with solid door (no glass).

Give your door an individual look

Enhance the look of your garage door with our attractive powder coated hardware or decorative hardware kits.



Spade - Stamped Steel



Spear - Wrought Iron



Elegant Handle

Additional hardware gives your garage door an individual look and adds overall curb appeal to your home.



AVAILABLE FROM:



Call us ► 1 877 OK HORMANN (1-877-654-6762)

Hörmann LLC, 5050 Baseline Road, Montgomery, Illinois 60538
Phone: 630-859-3000 Fax: 630-859-8122
Email: info@hormann.us www.hormann.us



Everything you've always wanted in a garage door, and more.

HÖRMANN